

JACKSON

Model 636 Jumbo Jack Pipe Stand

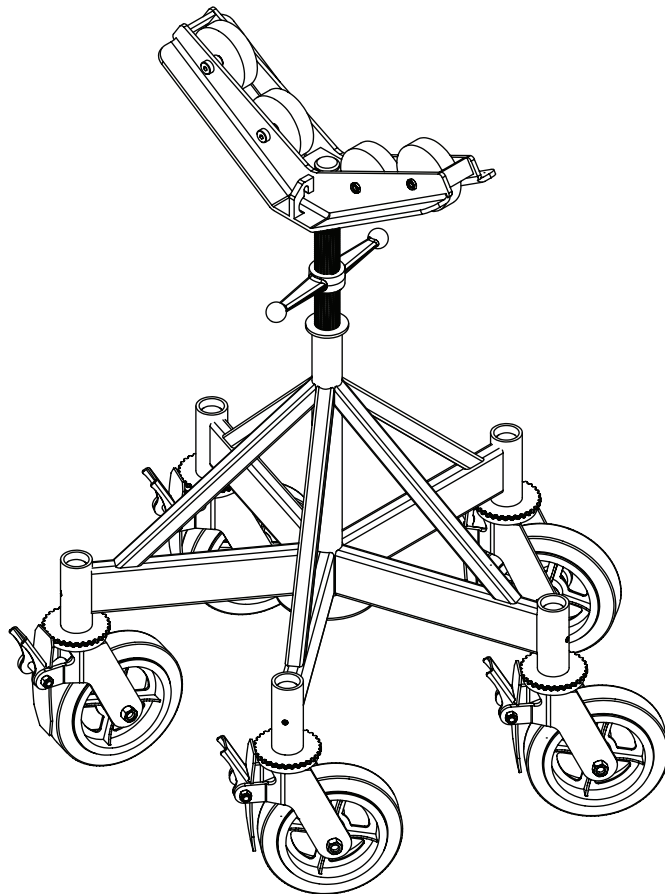

Assembly, Operating, Safety and Parts Manual

08/2016



Read and understand this material before operating or servicing the Jumbo Jack. Failure to understand how to safely operate and service this Pipe Stand may result in property damage, serious injury or death.

This manual is free of charge. All personnel who operate this Pipe Stand should have a copy of this manual and read and understand its contents. To request a copy, call or write to the address below.

JACKSON TOOL • P. O. BOX 5701 • GREENVILLE, SC 29606
877-522-8995 or 864-721-4235 • FAX 864-721-4236 • www.jacksonstoolinc.com

TABLE OF CONTENTS

| | |
|--|------|
| <i>Safety Alerts</i> | 2 |
| <i>Safety Information</i> | 3 |
| <i>Features</i> | 3 |
| <i>Specifications and Operating Instructions</i> | 4 |
| <i>Assembly Instructions</i> | 5 |
| <i>Exploded View and Parts List – 636</i> | 6 |
| <i>Exploded View and Parts List – 636NC</i> | 7 |
| <i>Hold Down Device Operating Instructions</i> | 8, 9 |
| <i>Hold Down Device Exploded View and Parts List</i> | 10 |

SAFETY ALERTS



Safety Alert Symbol

THIS SAFETY SYMBOL is used to call your attention to instructions that concern your personal safety. It means: ATTENTION! BE AWARE! THIS IS AN IMPORTANT SAFETY INSTRUCTION!

Read, understand and follow these safety instructions. Failure to follow these safety instructions may result in injury or death.



DANGER

Immediate hazards which, if not avoided, WILL result in serious personal injury or death.



WARNING

Hazards or unsafe practices which, if not avoided, COULD result in serious personal injury or death.



CAUTION

Hazards or unsafe practices which, if not avoided, COULD result in minor personal injury or property damage.

RETAIN SAFETY INFORMATION



This manual should be read and understood by all personnel who operate or service this Pipe Stand. Failure to understand how to safely operate and service this Pipe Stand could result in injury or death. This unit should only be operated or serviced by qualified personnel.

IMPORTANT SAFETY INFORMATION

Follow ALL safety information provided by the manufacturer.

- ⚠ WARNING** ALWAYS place the Pipe Stand on a smooth, level, firm surface that will support the weight of the load. NEVER use on dirt or gravel surface. Be sure all casters of the Pipe Stand make contact with the floor.
- ⚠ WARNING** ALWAYS be sure the pipe is properly placed onto the Pipe Stand. Improperly loaded pipe can cause tipping of the Pipe Stand, falling pipe and serious injury.
- ⚠ WARNING** ALWAYS inspect the Pipe Stand before each use. Never use if any part of the Pipe Stand is bent, deformed or broken.
- ⚠ WARNING** ALWAYS use a minimum of 2 Pipe Stands to support the pipe.
- ⚠ WARNING** ALWAYS use a hold down device for each Pipe Stand when transporting pipe.
- ⚠ WARNING** NEVER exceed the maximum rated capacity of the Pipe Stand.
- ⚠ WARNING** NEVER alter the Pipe Stand. Only use the Pipe Stand for its designed purpose.
- ⚠ WARNING** ALWAYS unlock and align casters before loading pipe on the Pipe Stands.
- ⚠ WARNING** ALWAYS adjust the V-head height prior to loading the pipe onto the Pipe Stands.
- ⚠ WARNING** NEVER drop pipe onto the Pipe Stand.
- ⚠ WARNING** NEVER load more than one pipe on the Pipe Stands.
- ⚠ WARNING** NEVER allow anyone under the pipe while it is supported by the Pipe Stand.
- ⚠ WARNING** NEVER use a hammer to reposition the casters. Damage can occur, possibly causing serious injury or death.
- ⚠ WARNING** Hold down device is to be used only to secure pipe to Pipe Stands. DO NOT use for any other purpose.
- ⚠ CAUTION** ALWAYS wear gloves and other safety equipment for your specific job when using the Pipe Stand.

FEATURES

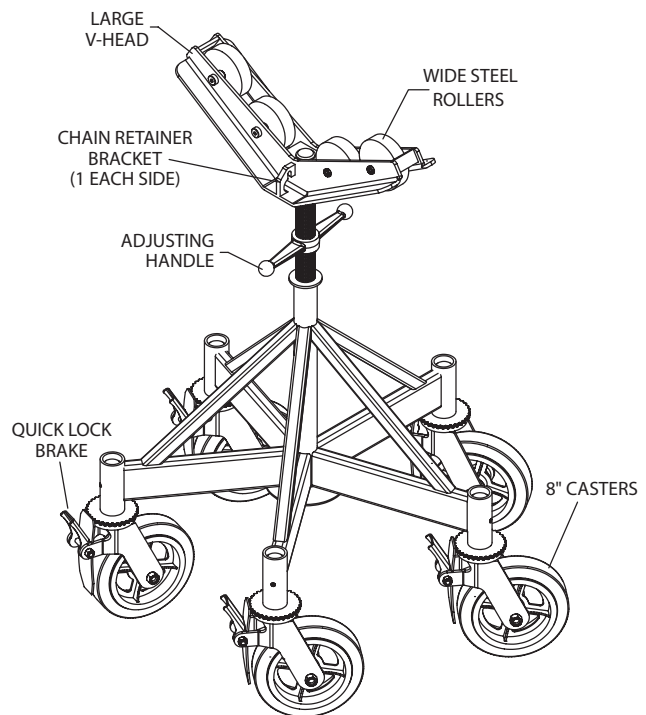

SPECIFICATIONS

| | | |
|-----------------------------|----------------------------|--------------------------|
| Model No. | 636 | 636NC (No Casters) |
| Pipe Size Capacity | 4" to 36" | 4" to 36" |
| Max. Weight Capacity | 2500 lbs. per Pipe Stand | 2500 lbs. per Pipe Stand |
| Overall Dimensions | W 35" H 36 $\frac{1}{4}$ " | W 35" H 28" |
| Weight | 130 lbs. | 90 lbs. |

OPERATING INSTRUCTIONS

1. Inspect the Pipe Stand before each use. Never use if any part of a Pipe Stand is bent, deformed or broken. Never modify or use a Pipe Stand that has been modified.
2. Place the Pipe Stand on a smooth, level, firm surface that will support the weight of the load. Be sure all casters of the Pipe Stand are making contact with the floor.
3. Always support the pipe with a minimum of two (2) Pipe Stands. Pipe size, weight and length are some of the factors to consider when supporting pipe with the Pipe Stands.
4. Using the adjusting handle, adjust the V-heads of the Pipe Stands so they are the same height. **ALWAYS** adjust the V-head height prior to loading the pipe onto the Pipe Stands. Be sure all the casters are unlocked and pointing in the same direction before loading the pipe onto the Pipe Stands.
5. Place the pipe onto the Pipe Stands. Never drop the pipe onto the Pipe Stands. Never exceed the maximum rated capacity of the Pipe Stands. Never allow anyone under the pipe while it is supported by the pipe stands.
6. Each caster on the Pipe Stand has a locking brake. To engage the brake, push down on the brake lever. To unlock the brake, lift up on the brake lever.

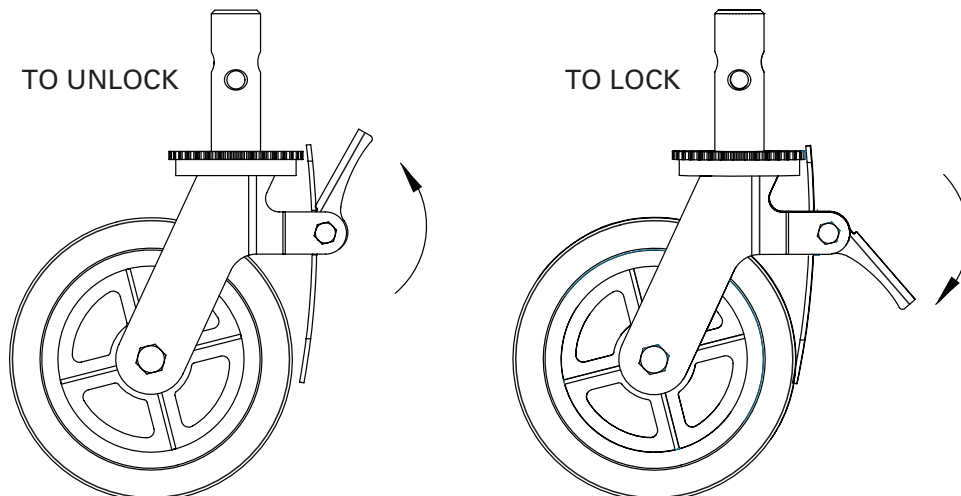

NOTE: The V-head rollers have an oilite bearing and do not need regular lubrication.

ASSEMBLY INSTRUCTIONS — 636 JUMBO JACK

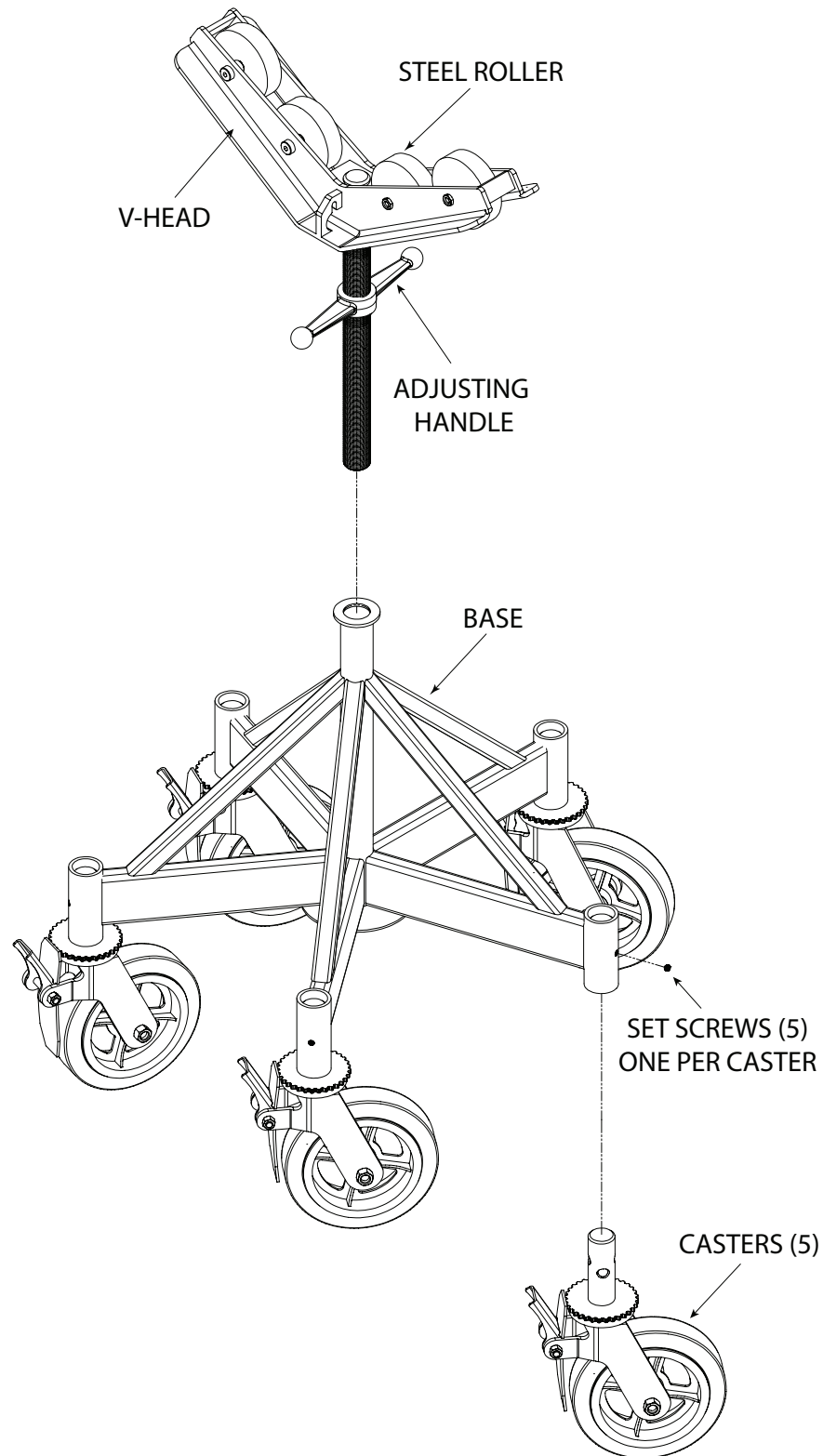

1. Fully insert five casters into base as shown and secure each with set screw provided.
2. Insert V-head into center tube of base.
3. Using adjusting handle, raise or lower V-head.

EXPLODED VIEW — 636 JUMBO JACK

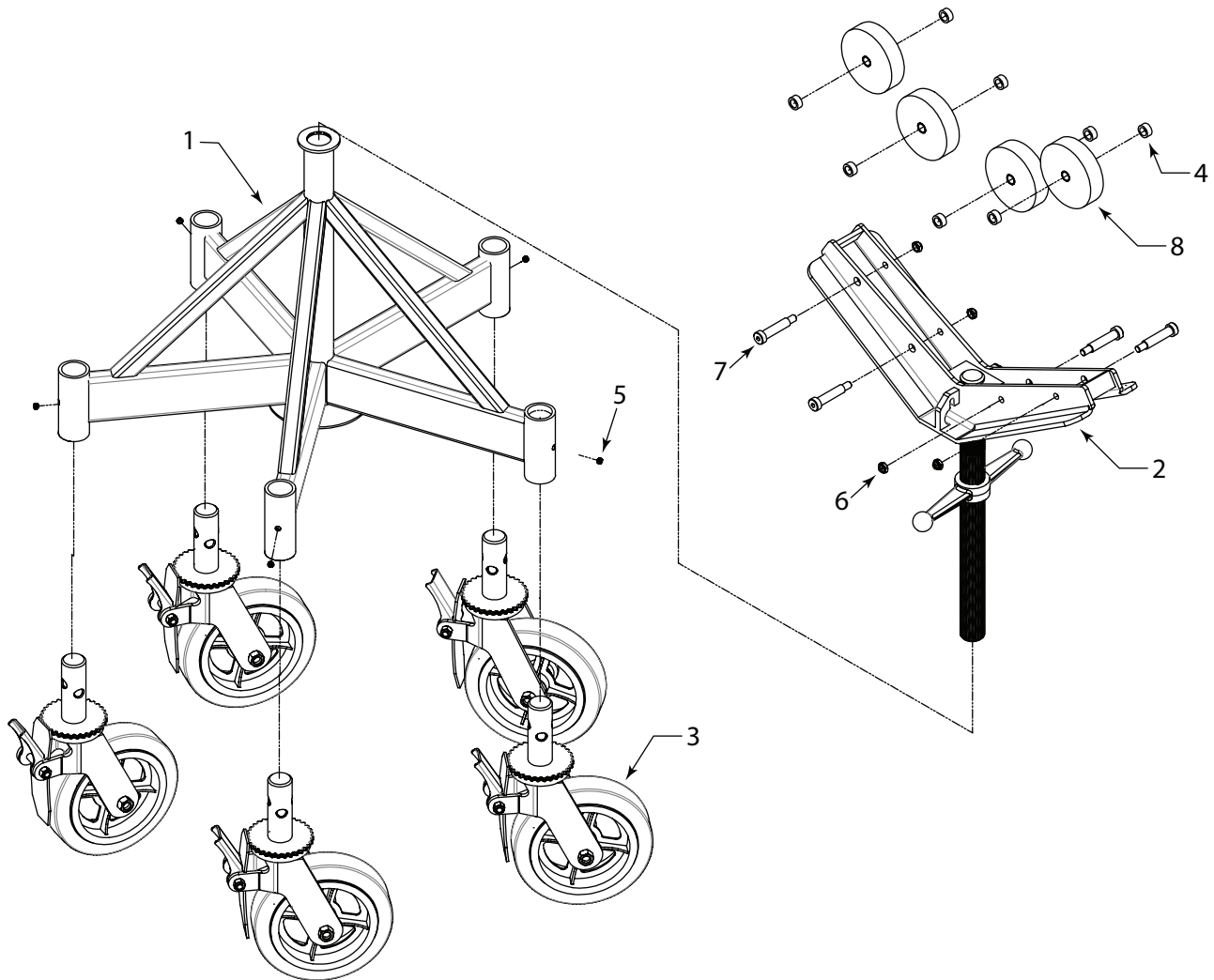

PARTS LIST — 636

| ITEM# | PART# | QTY | DESCRIPTION |
|-------|---------|-----|--|
| 1 | 636-861 | 1 | Base |
| 2 | 636-855 | 1 | V-Head |
| 3 | 636-2 | 5 | Caster |
| 4 | 636-846 | 8 | Spacer |
| 5 | 636-3 | 5 | Set Screw – $\frac{5}{16}$ "-18 X $\frac{1}{4}$ " Long |
| 6 | 302-2 | 4 | Nut – Hex, $\frac{3}{8}$ -16 (Nylon Insert – Thin) |
| 7 | 636-4 | 4 | Screw – Shoulder $\frac{1}{2}$ " X 2" Long |
| 8 | 636-895 | 4 | Roller |

ASSEMBLY INSTRUCTIONS — 636NC

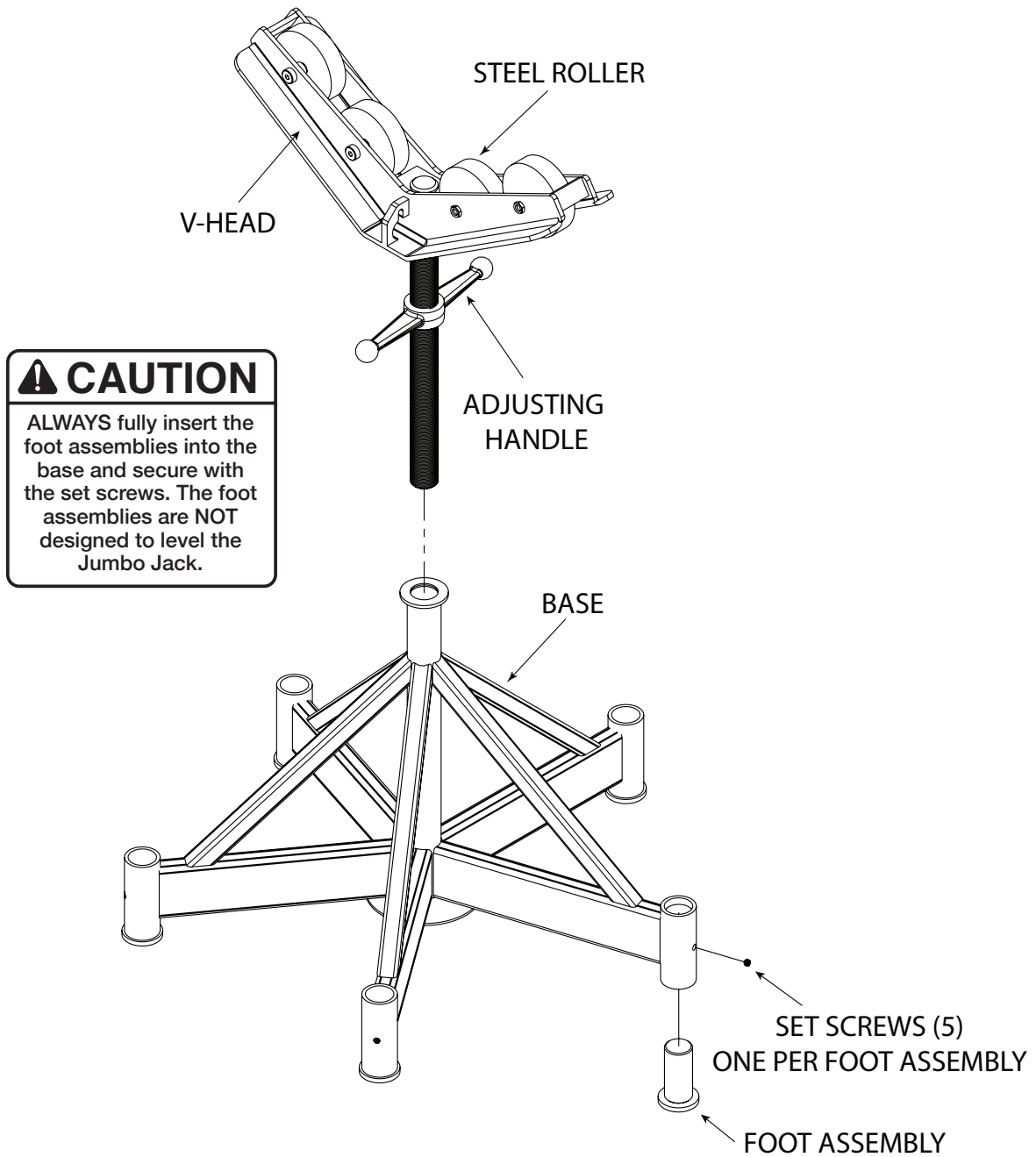

1. Fully insert five foot assemblies into the base as shown and secure each with set screw provided.
2. Insert V-head into center tube of base.
3. Using adjusting handle, raise or lower V-head.

EXPLODED VIEW – 636NC

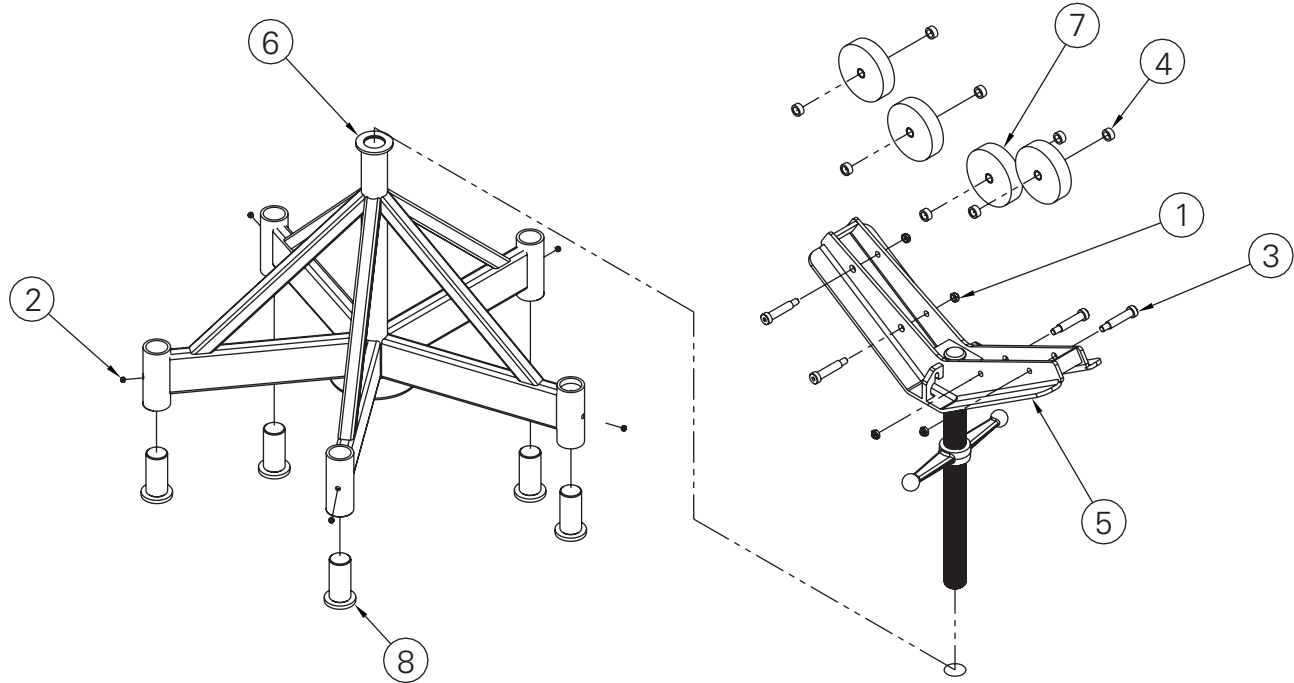

PARTS LIST — 636NC

| ITEM# | PART# | QTY | DESCRIPTION |
|-------|---------|-----|--|
| 1 | 302-2 | 4 | Nut – Hex, $\frac{3}{8}$ -16 (Nylon Insert – Thin) |
| 2 | 636-3 | 5 | Screw – Socket Set ($\frac{5}{16}$ "-18 X $\frac{1}{4}$ ") Cup Pt |
| 3 | 636-4 | 4 | Screw – Shoulder, ($\frac{1}{2}$ " X 2") |
| 4 | 636-846 | 8 | Spacer |
| 5 | 636-855 | 1 | V-Head |
| 6 | 636-861 | 1 | Base |
| 7 | 636-895 | 4 | Roller |
| 8 | 636-902 | 5 | Foot Assembly |

HOLD DOWN DEVICE OPERATING INSTRUCTIONS

WARNING

Hold down device is only to secure pipe to the Jumbo Jack Pipe Stand.
DO NOT use for any other purpose.

1. Insert the loose end of the chain through one of the chain retainer brackets located on the V-head (See photo 1) until the hold down bracket is located at the top of the pipe (See photo 2).

NOTE: There is a chain retainer bracket located on both sides of the V-head.
Either one may be used.

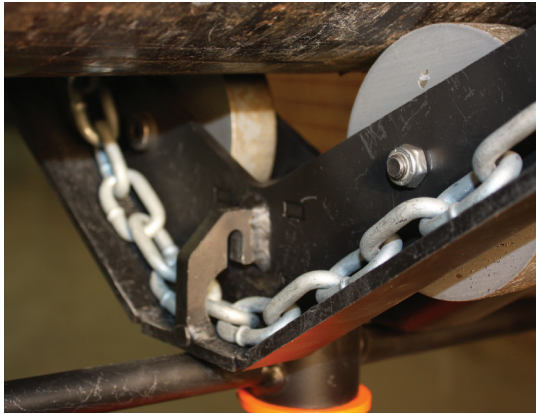

Photo 1



Photo 2

2. In order that you have the maximum amount of adjustment travel, adjust the handle/nut so that the nut is flush with the end of the acme screw. (See photo 3.)



Photo 3

3. Pull the loose end of the chain around the pipe until snug and place the end of a chain link into the hook on the hold down bracket (See photo 4).



Photo 4

HOLD DOWN DEVICE OPERATING INSTRUCTIONS

4. As you tighten the chain with the handle/nut, check to ensure that a link of the chain engages the chain retainer slot (See photo 5).

NOTE: If the chain does not tighten before you run out of adjustment, loosen the handle/nut and place the next link of the chain into the hook on the hold down bracket. Be sure the hold down bracket and chain are in line with the chain retainer to ensure the chain remains tight. (See photos below).



Photo 5

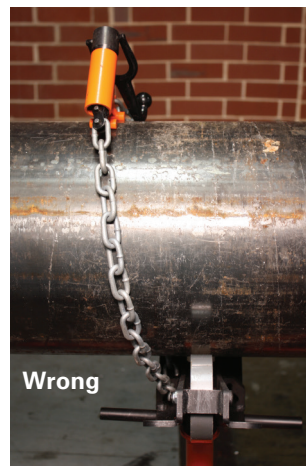
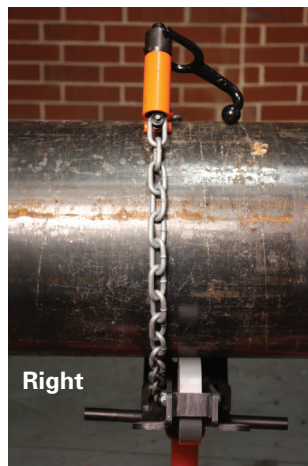

ALWAYS use a hold down device with each pipe stand when transporting pipe.

5. Before transporting, align the casters as follows:

A. Unlock ALL caster brakes (See page 4).

B. Rotate the pipe stand base in a circular motion to align casters.

⚠ WARNING NEVER use a hammer to reposition the casters. Damage could occur causing serious injury or death.

6. Ready for transport. (See photo to right).

⚠ WARNING ALWAYS push or pull the load from the end. DO NOT stand to the side of the load while transporting.



HOLD DOWN DEVICE #636-851 EXPLODED VIEW AND PARTS LIST

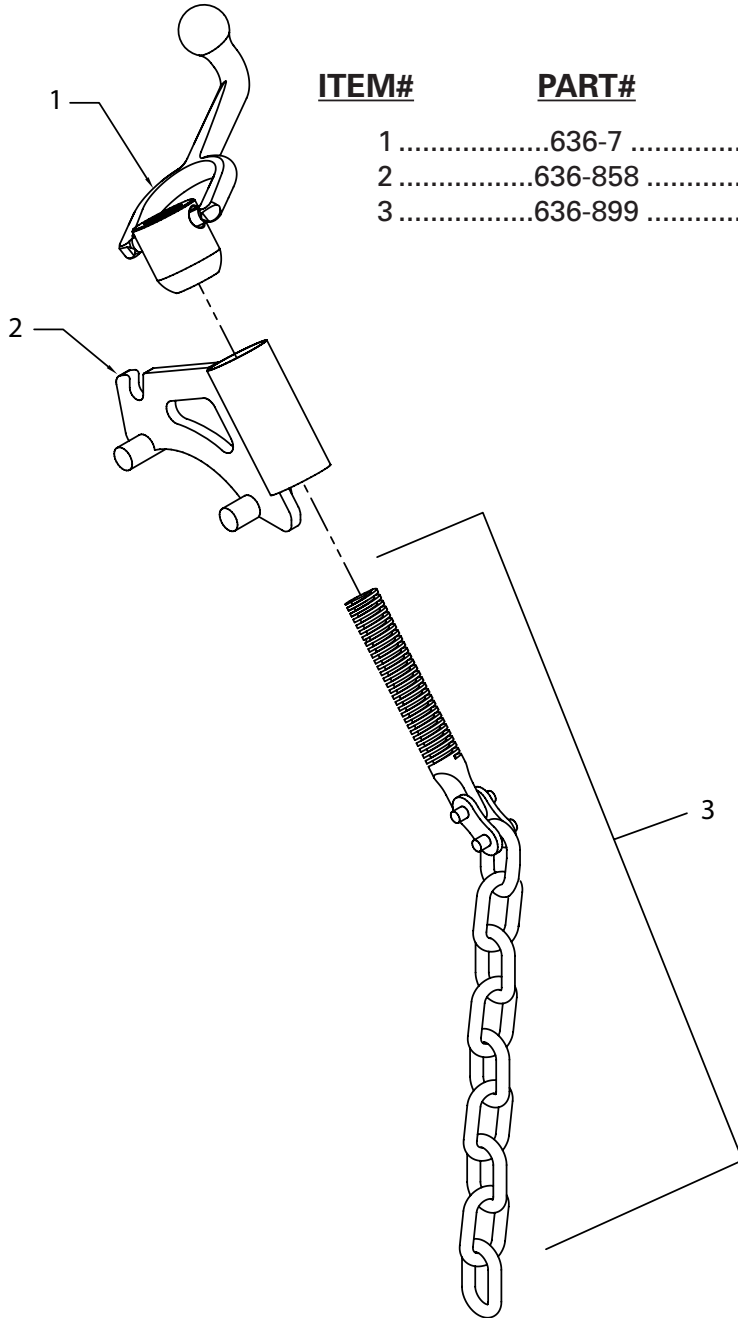

| <u>ITEM#</u> | <u>PART#</u> | <u>QTY</u> | <u>DESCRIPTION</u> |
|--------------|--------------|------------|---------------------------|
| 1 | 636-7 | 1 | Handle/Nut |
| 2 | 636-858 | 1 | Hold Down Bracket |
| 3 | 636-899 | 1 | Acme Screw/Chain Assembly |