

JACKSON

Model 440DL 4 Leg V-Head Pipe Stand

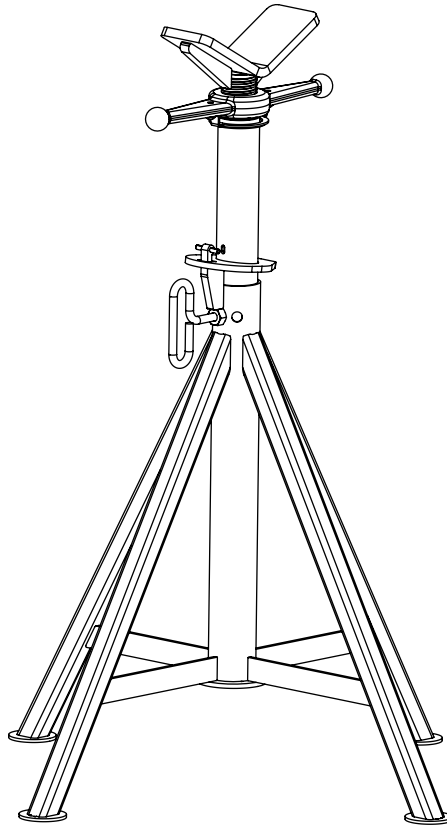

Operating, Safety and Parts Manual



Read and understand this material before operating or servicing the Pipe Stand. Failure to understand how to safely operate and service this unit may result in property damage, serious injury or death.

02/2021

This manual is free of charge. All personnel who operate the Pipe Stand should have a copy of this manual and read and understand its contents. To request a copy of this manual or replacement safety decals, or for technical assistance, call or write to the address below. All information, specifications and product designs may change due to design improvements or updates and are subject to change without notice. Jackson Tool does not assume any liability for damages resulting from misuse or incorrect application of its products.

JACKSON TOOL • P. O. BOX 5701 • GREENVILLE, SC 29606
877-522-8995 or 864-721-4235 • FAX 864-721-4236 • www.jacksonstoolinc.com

TABLE OF CONTENTS

Safety Alerts	2
Safety Information	3
Features	4
Specifications	4
Operating Instructions	5
Transporting Instructions	5
Exploded View and Parts List – 440DL	6
Optional Hold Down Device Operating Instructions	7,8
Exploded View and Parts List – 436DL-200	9

SAFETY ALERTS



Safety Alert Symbol

THIS SAFETY SYMBOL is used to call your attention to instructions that concern your personal safety. It means: ATTENTION! BE AWARE! THIS IS AN IMPORTANT SAFETY INSTRUCTION!

Read, understand and follow these safety instructions. Failure to follow these safety instructions may result in injury or death.



DANGER

Immediate hazards which, if not avoided, WILL result in serious personal injury or death.



WARNING

Hazards or unsafe practices which, if not avoided, COULD result in serious personal injury or death.



CAUTION

Hazards or unsafe practices which, if not avoided, COULD result in minor personal injury or property damage.

RETAIN SAFETY INFORMATION



This manual should be read and understood by all personnel who operate or service this Pipe Stand. Failure to understand how to safely operate and service this unit could result in injury or death. This unit should only be operated or serviced by qualified personnel.

IMPORTANT SAFETY INFORMATION

Follow ALL safety information provided by the manufacturer.

- ▲ WARNING** ALWAYS place the Pipe Stand on a smooth, level, firm surface that will support the weight of the load. NEVER use on dirt or gravel surface. Be sure all feet of the Pipe Stand make contact with the floor.
- ▲ WARNING** ALWAYS be sure the pipe is properly placed onto the Pipe Stand. Improperly loaded pipe can cause tipping of the Pipe Stand, falling pipe and serious injury.
- ▲ WARNING** ALWAYS inspect the Pipe Stand before each use. Never use if any legs or other part of the Pipe Stand is bent, deformed, broken or has been modified.
- ▲ WARNING** ALWAYS adjust the quick height adjustment tube prior to loading pipe onto the stand.
- ▲ WARNING** NEVER exceed the maximum rated capacity of the Pipe Stand.
- ▲ WARNING** NEVER alter the Pipe Stand. Only use for its designed purpose.
- ▲ WARNING** NEVER drop pipe onto the Pipe Stand.
- ▲ WARNING** NEVER allow anyone under the pipe while it is supported by the Pipe Stand.
- ▲ WARNING** ALWAYS use a minimum of 2 Pipe Stands to support the pipe.
- ▲ WARNING** NEVER load more than one pipe onto the Pipe Stand.
- ▲ WARNING** DO NOT release lock ring with a load on the stand.
- ▲ WARNING** DO NOT exceed recommended working height of stand.
- ▲ WARNING** NEVER raise the quick height adjustment tube past the sight hole.
- ▲ WARNING** ALWAYS carry the Pipe Stand by both the V-Head assembly and the base. This will help prevent injury from an improperly secured assembly.
- ▲ WARNING** ALWAYS make sure the lock ring is properly placed on the lock ring retainer and the roll pin is in place.
- ▲ WARNING** ONLY use Jackson Tool replacement parts on the Pipe Stand. Use of parts not supplied by Jackson Tool WILL NOT work properly on the Pipe Stand and could result in serious personal injury or death.
- ▲ WARNING** BE SURE the pipe rests in the center of the V-Head and that the pipe is level as it sits on the pipe stands.
- ▲ CAUTION** ALWAYS wear gloves and other safety equipment for your specific job when using the Pipe Stand.

FEATURES

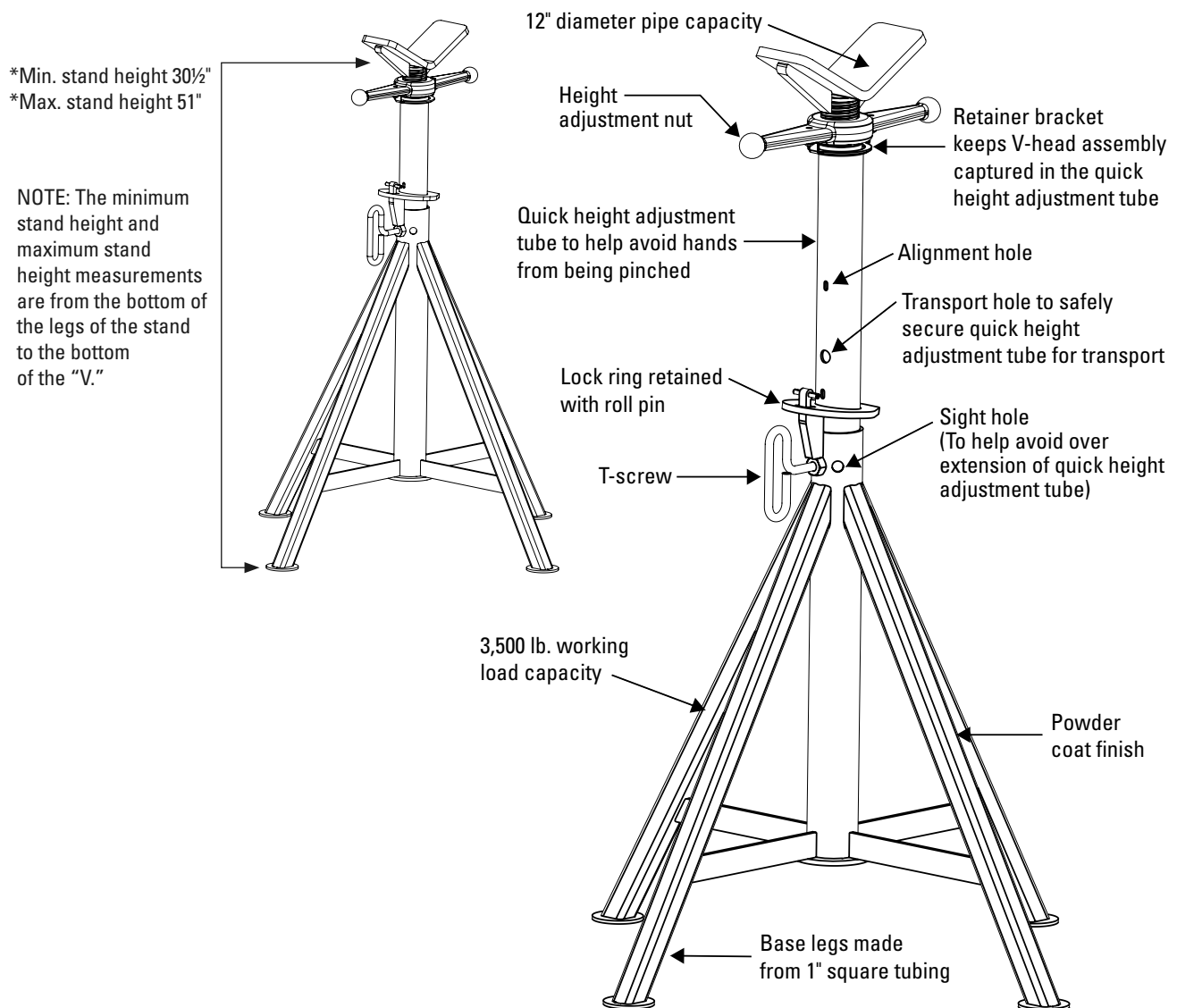

SPECIFICATIONS

Model No.	440DL
Pipe Size Capacity	1/2" to 12"
Max. Weight Capacity	3500 lbs. per Stand
Overall Dimensions	L18½" W18½" H32½" (fully retracted)
Min. Stand Height	30½"*
Max. Stand Height	51"*
Weight	26 lbs.

*See drawing in the features section above

OPERATING INSTRUCTIONS

1. Inspect the Pipe Stand before each use. NEVER use if any legs or other part of the stand is bent, deformed, broken or has been modified.
2. Place the Pipe Stand on a smooth, level, firm surface that will support the weight of the load. Be sure all feet of the stand make contact with the floor.
3. With no load on the Pipe Stand, loosen the T-screw. Grasp the quick height adjustment tube and lift to desired height. NOTE: DO NOT raise the quick height adjustment tube past the sight hole. If you are not able to see the quick height adjustment tube in the sight hole, lower the quick height adjustment tube until it completely fills the sight hole. Release the quick height adjustment tube and ensure that the lock ring has engaged. This will help prevent the quick height adjustment tube from lowering further. **NOTE:** ALWAYS make sure the lock ring is properly placed on the lock ring retainer and the roll pin is in place. See Figure 5.
4. Securely tighten the T-screw.
5. Turn the height adjustment nut to the desired height. For adjustment purposes, leave approximately 2" to 3" of thread showing under the "V". NOTE: use only hand pressure to turn the height adjustment nut.
6. Place the pipe onto the pipe stands. Be sure the pipe rests in the center of the V-Head and that the pipe is level as it sits on the pipe stands.

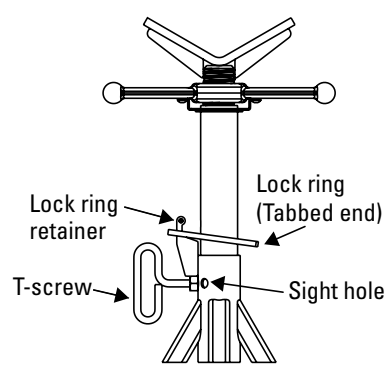

CORRECT PLACEMENT OF LOCK RING

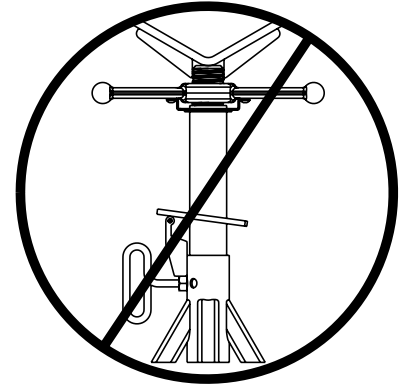

INCORRECT PLACEMENT OF LOCK RING

Figure 5

WARNING

ALWAYS support the pipe with a minimum of two (2) Pipe Stands. Place stands to properly support the pipe. Pipe size, weight and length are some of the factors to consider when supporting pipe with the Pipe Stands.

WARNING

NEVER drop the pipe onto the pipe stands. NEVER exceed the maximum rated capacity of the pipe stands. To avoid tipping, be sure the Pipe Stands are properly aligned, the pipe rests in the center of the V-Head and the pipe is level as it sits on the pipe stands. Never allow anyone under the pipe while it is supported by the stands.

NOTE: After pipe is removed from the stands, lower the stands by loosening the T-Screw. Then securely grasp the quick height adjustment tube and lift up on the tabbed end of the lock ring.

TRANSPORTING INSTRUCTIONS

1. DO NOT move the stand(s) until the pipe has been removed.
2. Remove the pipe hold down device if it is being used.
3. Turn the height adjustment nut to fully lower the head assembly.
4. Loosen the T-screw.
5. Securely grasp the quick height adjustment tube and lift up on the tabbed end of the lock ring. While continuing to lift the lock ring, COMPLETELY lower the quick height adjustment tube. Place the alignment hole in line with the lock ring retainer.
6. To secure the stand for transport, tighten the T-screw through the transport hole in the quick height adjustment tube until it tightens. Stand will then be ready for transport.

EXPLODED VIEW — 440DL 4 LEG PIPE STAND

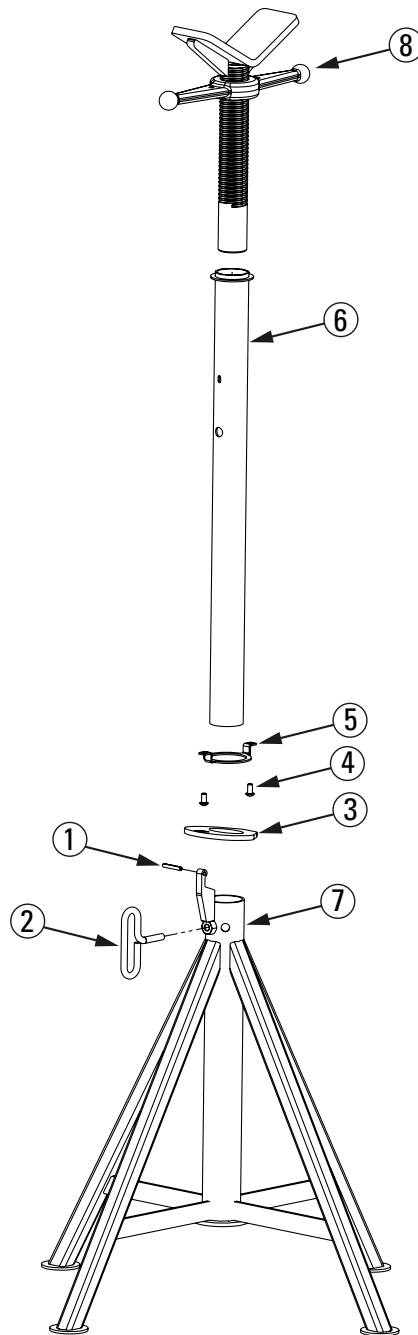

PARTS LIST — 440DL 4 LEG PIPE STAND

ITEM#	PART#	QTY	DESCRIPTION
1	186-20	1	PIN – ROLL (3/16" × 1.25")
2	2508-581	1	T-SCREW
3	436-088	1	LOCK RING
4	436-112	2	SCREW, BUTTON HEAD SOCKET – 1/4-20 × 1/2"
5	436DL-103	1	RETAINER BRACKET
6	436DL-122	1	QUICK HEIGHT ADJUSTMENT TUBE
7	440DL-104	1	4 LEG BASE
8	440DL-106	1	V-HEAD ASSEMBLY

OPTIONAL HOLD DOWN DEVICE 436DL-200 OPERATING INSTRUCTIONS



WARNING

Hold down device is only to secure pipe to the Pipe Stand.
DO NOT use for any other purpose.

1. Place the hold down device on top of the pipe, in line with the center of the pipe stand base (See photo 1).
2. In order that you have the maximum amount of adjustment travel, adjust the handle/nut so that the nut is flush with the end of the acme screw. (See photo 2.)
3. Pull the loose end of the chain and wrap once around the acme threaded rod. Chain should be under the V and above the height adjustment nut (See photo 3.)
4. Continue the chain around the pipe and pull as tight as possible. Insert chain link onto the hook of the hold down bracket (See photo 4).



Photo 1



Photo 2



Photo 3



Photo 4

OPTIONAL HOLD DOWN DEVICE #436 DL-200 OPERATING INSTRUCTIONS – CONTINUED

5. Turn hold down device handle/nut to tighten chain. As you tighten the chain with the handle/nut, check to ensure that the full length of the chain tightens against the pipe. (See photo 5).

NOTE: If the chain does not tighten before you run out of adjustment, loosen the handle/nut and place the next link of the chain into the hook on the hold down bracket. Be sure the hold down bracket and chain are in line with the V-head assembly to ensure the chain remains tight. (See photos below).



Photo 5



Right



Wrong

HOLD DOWN DEVICE #436DL – 200 **EXPLODED VIEW AND PARTS LIST**

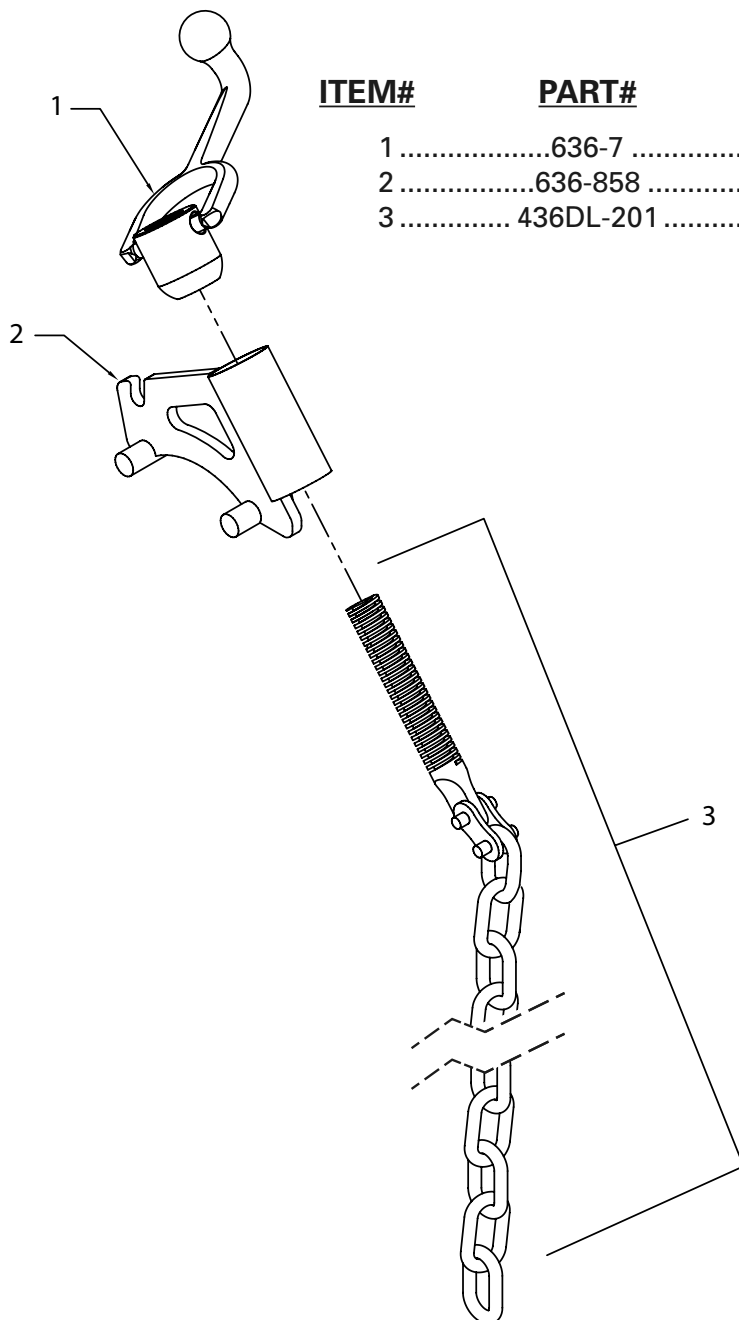

<u>ITEM#</u>	<u>PART#</u>	<u>QTY</u>	<u>DESCRIPTION</u>
1	636-7	1	Handle/Nut
2	636-858	1	Hold Down Bracket
3	436DL-201	1	Acme Screw/Chain Assembly