

# PRODUCT CATALOG

# JACKSON





## TABLE OF CONTENTS

<b>Model 186</b> Chain Vise Stand 1/8" to 6" Capacity.....	148
<b>Model 436</b> V-Head Pipe Stand.....	149
<b>V-Head Pipe Stand Options – complete units</b> .....	150
<b>Optional Heads for Model 436</b> Pipe Stand .....	151
<b>Model 436DL</b> Deluxe V-Head Pipe Stand .....	152
<b>Model 440DL</b> Deluxe 4 Leg V-Head Pipe Stand.....	153
<b>Model 536</b> Pipe Horse™ Pipe Stand .....	154
<b>Model 636</b> Jumbo Jack™ Pipe Stand.....	155
<b>Model 301 – 302 – 303</b> Tri-Clamp™ Pipe Alignment Tool .....	156
<b>Model 5050</b> Pipe / Conduit Rack .....	157
<b>Model 5070</b> Pipe / Conduit Bundler .....	158
<b>Model 5080</b> Pipe / Material Cart.....	159
<b>Model 5090</b> Mobile Container Cart .....	160
<b>Model 458</b> Pipe Wagon .....	161
<b>Model 2508</b> Yard Dog™ Pipe Hauler.....	162
<b>Model 5050H</b> and <b>Model 5050HL</b> Pipe Hanger Cart.....	163
<b>Model 5400</b> Wire Cage.....	164
<b>Model 224W</b> Rolling Threader Stand with tray .....	165
<b>Model 235W</b> Rolling Threader Stand with storage box.....	165
<b>Model 142</b> JP Jaws for PVC coated conduit .....	166
<b>Comparison Reference</b> .....	167

# JACKSON

## Model 186 Chain Vise Stand $\frac{1}{8}$ " to 6" Capacity

- Heavy duty jaws provide strong grip and long life
- Collapsible tool tray provides stability when open and folds up for ease of transport
- Large head unit that will handle up to 6" diameter pipe and includes ceiling brace screw
- Slots cast into head unit to hang tools during use
- Jaws for PVC coated conduit available (optional)
- Comes completely assembled and ready for use
- Powder coated



\* See Page 166 for JP Jaw Set for use with Ridgid® \* 40A Tri-Stand Yoke Vise

SCAN HERE FOR MANUAL



CATALOG NUMBER	DESCRIPTION	CAPACITY	WEIGHT	
186	Chain Vise Stand	Up to 6" Diameter Pipe	48 lbs.	UPC# 811993024580

\*RIDGID® is a registered trademark of Emerson Electric, Inc.

# JACKSON

## Model 436 V-Head Pipe Stand

- 1/2"-12" diameter pipe capacity
- 2,500 lb. working load capacity per stand
- Quick height adjustment tube
- Height adjustment nut for fine tuning height
- Sight hole to help avoid over extension of height adjustment tube
- Safety feature allows V-Head to be secured for transport
- Powder coated



SCAN HERE FOR MANUAL



CATALOG NUMBER	DESCRIPTION	CAPACITY	WEIGHT	
436	V-Head Pipe Stand	Load – 2,500 lbs.	21 lbs.	UPC# 811993025327
		1/2"-12" Pipe diameter		



# JACKSON

## V-Head Pipe Stand Options – Complete Units



### PIPE STAND MODEL NUMBER AND DESCRIPTIONS including accessory heads

COMPLETE STANDS	
PART#	DESCRIPTION
436	Base with standard V-Head
1436BT	Base with steel roller ball transfer head
1436BTS	Base with stainless steel roller ball transfer head
1438	Base with steel wheel head
1438SS	Base with stainless steel wheel head
1437	Base with plastic wheel head
1439	Base with bar stock head
1436V	Base with stainless steel V-head sleeve attachment

# JACKSON

## Optional Heads for Model 436 Pipe Stands

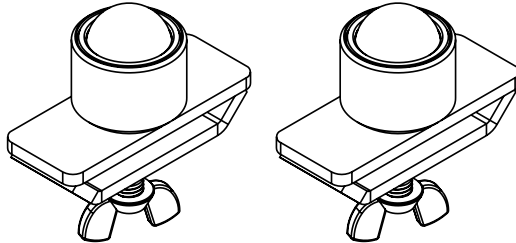

**436BT — Steel**  
**436BTS — Stainless Steel**  
**BALL TRANSFER HEAD ATTACHMENT SET**

Capacity: 1,000 lbs/set  
 3/8" to 12" diameter pipe or tube

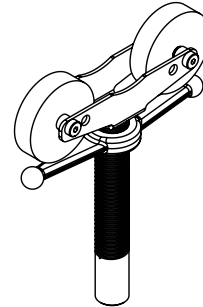

**438 — Steel**  
**438SS — Stainless Steel**  
**STEEL WHEEL HEAD**

Capacity: 2,000 lbs  
 1½" to 12" diameter pipe on inside roller setting  
 12" to 24" diameter pipe on outside roller setting

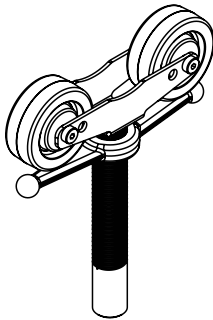

**437**  
**PLASTIC WHEEL HEAD**

Capacity: 1,000 lbs  
 1½" to 12" diameter pipe on inside roller setting  
 12" to 24" on outside roller setting

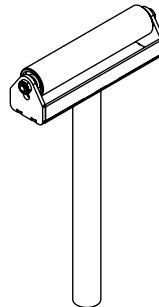

**439**  
**BAR STOCK HEAD**

Capacity: 2,000 lbs.  
 1/8" to 10" wide flats, bars and beams

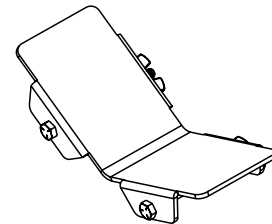

**436V**  
**STAINLESS STEEL V-HEAD SLEEVE ATTACHMENT**

Capacity: 2,500 lbs  
 1/2"–12" diameter pipe

SCAN HERE FOR MANUAL



CATALOG NUMBER	DESCRIPTION	CAPACITY	UPC#
436BT	Ball transfer head attachment set — steel	1,000 lbs/set	UPC# 811993026300
436BTS	Ball transfer head attachment set — stainless steel	1,000 lbs/set	UPC# 811993026317
438	Wheel head — steel	2,000 lbs	UPC# 811993026324
438SS	Wheel head — stainless steel	2,000 lbs	UPC# 811993026171
437	Wheel head — plastic	1,000 lbs	UPC# 811993026331
439	Bar stock head	2,000 lbs	UPC# 811993026348
436V	V-Head sleeve attachment — stainless steel	2,500 lbs	UPC# 811993026355

# JACKSON

## Model 436DL *Deluxe V-Head Pipe Stand*

- V-Head assembly secured to quick height adjustment tube to help prevent pinch points
- Height adjustment tube has 5" clearance when fully lowered to help avoid pinch points
- 1/2"-12" diameter pipe capacity
- 2,500 lb. working load capacity per stand
- Permanently secured lock ring
- Sight hole to help prevent over extension of height adjustment tube
- Safety feature allows V-Head to be secured for transport
- Powder coated finish
- Optional pipe hold down device



SCAN HERE FOR VIDEO



SCAN HERE FOR MANUAL



CATALOG NUMBER	DESCRIPTION	CAPACITY	WEIGHT	
436DL	Deluxe V-Head Pipe Stand	Load – 2,500 lbs.	21 lbs.	UPC# 811993026201
		1/2"-12" Pipe diameter		

# JACKSON

## Model 440DL Deluxe 4 Leg V-Head Pipe Stand

- 4 leg base for added stability
- V-Head assembly secured to quick height adjustment tube to help prevent pinch points
- Height adjustment tube has 5" clearance when fully lowered to help avoid pinch points
- 1/2"–12" diameter pipe capacity
- 3,500 lb. working load capacity per stand
- Permanently secured lock ring
- Sight hole to help prevent over extension of height adjustment tube
- Safety feature allows V-Head to be secured for transport
- Powder coated finish



SCAN HERE FOR MANUAL



CATALOG NUMBER	DESCRIPTION	CAPACITY	WEIGHT	
440DL	Deluxe 4 Leg V-Head Pipe Stand	Load — 3,500 lbs.	22 lbs.	UPC# 811993027130
		1/2"–12" pipe diameter		

# JACKSON

## Model 536 Pipe Horse™ Pipe Stand

- Holds 1/2" to 36" diameter pipe
- 2,500 lb. capacity per stand with steel wheels
- 1,000 lb. capacity per stand with phenolic wheels
- Locking screw on both rollers
- Nut on both ends of unit for easy adjustment
- Powder coated
- Available with steel or phenolic wheels



SCAN HERE FOR MANUAL



CATALOG NUMBER	DESCRIPTION	CAPACITY	WEIGHT	
536	Pipe Horse™ Pipe Stand	Load – 2,500 lbs.	35 lbs.	UPC# 811993024559
		1/2"-36" Pipe diameter		
536P	Pipe Horse™ Pipe Stand with Phenolic Wheels	Load – 1,000 lbs.	35 lbs.	UPC# 811993026287
		1/2"-36" Pipe diameter		

# JACKSON

## Model 636 Jumbo Jack™ Pipe Stand

- Holds 4" to 36" Diameter Pipe
- 2,500 lb. capacity per stand
- 5 heavy duty swivel casters with locking brake
- Optional Hold Down Device to secure pipe to stand
- Extra wide rollers on V-Head provide additional stability
- Powder coated



OPTIONAL HOLD DOWN DEVICE  
PART #636-851



SCAN HERE FOR MANUAL



CATALOG NUMBER	DESCRIPTION	CAPACITY	WEIGHT	
636	Jumbo Jack™ Pipe Stand	Load – 2,500 lbs.	130 lbs.	UPC# 811993024566
		4"-36" Pipe diameter		
636NC	Jumbo Jack Pipe Stand — No Casters	Load – 2,500 lbs.	90 lbs.	UPC# 811993026706
		4"-36" Pipe diameter		
636-851	Hold Down Device (optional)	Up to 36" Pipe	5 lbs.	UPC# 811993024993



# JACKSON

## Model 301 – 302 – 303 Tri-Clamp™ Pipe Alignment Tool

- Three size ranges covering 1" through 12" diameters
- Durable steel frame is ideal for job site use as well as shop use
- Strong and lightweight for increased productivity and long tool life
- Versatile tool can be used for multiple fit-ups, including Pipe to Pipe, Pipe to Fitting, Pipe to Flange and Pipe to Tee
- Powder coated

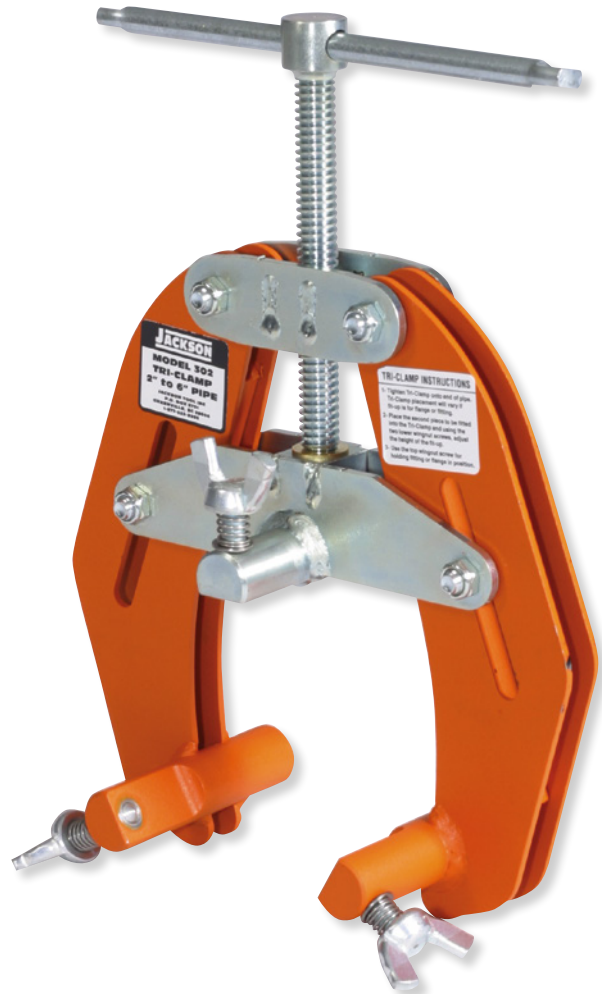

SCAN HERE FOR MANUAL



CATALOG NUMBER	DESCRIPTION	CAPACITY	WEIGHT	
301	Tri-clamp, small	1" to 2½" diameter	3 lbs.	UPC# 811993024955
302	Tri-clamp, medium	2" to 6" diameter	9 lbs.	UPC# 811993024962
303	Tri-clamp, large	5" to 12" diameter	15 lbs.	UPC# 811993024979

# JACKSON

## Model 5050 Pipe / Conduit Rack

- For organizing pipe or conduit
- 7 spaces for sorting
- Arms fold down to save space
- Provided with large 6" casters; 2 swivel and 2 fixed
- Powder coated
- Caster plates inset to allow stacking of carts with casters attached



*Better than the rest!  
Arms designed with  
one piece construction*

SCAN HERE FOR MANUAL



CATALOG NUMBER	DESCRIPTION	CAPACITY	WEIGHT	
5050	Pipe/Conduit Rack	1,000 lbs.	111 lbs.	UPC# 811993024573

# JACKSON

## Model 5070 Pipe / Conduit Bundler with Casters

- Designed for easy movement of large bundles of pipe or conduit on the job site
- Welded construction for years of job site use
- Provided with large 6" casters; 2 swivel and 2 fixed
- Powder coated
- Caster plates inset to allow stacking of carts with casters attached



SCAN HERE FOR MANUAL



CATALOG NUMBER	DESCRIPTION	CAPACITY	WEIGHT	
5070	Pipe/Conduit Bundler with Casters	1,000 lbs.	112 lbs.	UPC# 811993025099

# JACKSON

## Model 5080 Pipe/Material Cart



Shown with  
4 corner post inserts  
and pipe supports

- Easily transport pipe and material around the job site
- 2,000 lb. capacity
- Removable pipe supports
- Pipe support design provides clearance under pipe for loading/unloading
- 6 heavy duty casters — 2 center casters for ease of rolling and making tight turns
- Corner post inserts allow transporting of material up to 34" in height
- Stackable when not in use for compact storage



Corner post inserts  
come standard



Pipe supports come  
standard



Stackable



SCAN HERE FOR MANUAL



CATALOG NUMBER	DESCRIPTION	CAPACITY	WEIGHT	
5080	Pipe/Material Cart	2,000 lbs.	176 lbs.	UPC# 811993026188

# JACKSON

## Model 5090 *Mobile Container Cart*

- Designed for easy movement of materials around the job site.
- Heavy duty mesh for strength and visibility of material
- Provided with large 6" casters; 2 swivel locking and 2 fixed
- Powder coated
- Stackable to save space when not in use
- Fits through standard 32" doorway
- Made in USA



SCAN HERE FOR MANUAL



CATALOG NUMBER	DESCRIPTION	CAPACITY	WEIGHT	
5090	Mobile Container Cart Dimensions – 60"L x 31.5"W x 42"H	1,500 lbs.	185 lbs.	UPC# 811993027116

# JACKSON

## Model 458 *Pipe Wagon*

- Transports up to 20' lengths of pipe
- 1000 lb. capacity
- Large pneumatic tires move load with ease
- Ergonomically designed handle
- Heavy duty construction
- Powder coated



SCAN HERE FOR MANUAL



CATALOG NUMBER	DESCRIPTION	WEIGHT	
458	Pipe Wagon Capacity – 1,000 lbs.	92 lbs	UPC# 811993024986



# JACKSON

## Model 2508 *Yard Dog™ Pipe Hauler*



- Ability for one person to lift and transport up to 2000 lb. loads
- Durable wheels and tires to handle the abuse of constant job site use
- Variable load lengths accomodated by sliding chain blocks
- Cushioned grips help ease operator fatigue
- Powder coated



SCAN HERE FOR MANUAL



CATALOG NUMBER	DESCRIPTION	CAPACITY	WEIGHT	
2508	Yard Dog Pipe Hauler	20" diameter pipe up to 20' long 2000 lbs. maximum	184 lbs.	UPC# 811993024894

# JACKSON

## Model 5050H and 5050HL Pipe Hanger Cart

- Organize and move pipe hangers around the jobsite
- Holds 120 – 2" to 4" pipe hangers or 40 – 6" to 8" pipe hangers
- Solid thru-bar construction
- Fast set up
- Fits through standard 36" doorway
- Provided with large 6" casters, 2 swivel and 2 fixed
- Folds for compact storage
- Stackable design saves space when not in use



MODEL 5050H



SCAN HERE FOR MANUAL

SCAN HERE FOR VIDEO



CATALOG NUMBER	DESCRIPTION	CAPACITY	WEIGHT	
5050H	Pipe Hanger Cart with Mesh Base	1,000 lbs. (evenly distributed)	208 lbs.	UPC# 811993026669
5050HL	Pipe Hanger Cart	1,000 lbs. (evenly distributed)	198 lbs.	UPC# 811993027215

# JACKSON

## Model 5400 Wire Cage

- Heavy duty wire mesh cage, great for storage on or off the jobsite
- Door frames made of square tubing; much sturdier than the competition
- Lockable doors for added security
- Removable steel shelves that will also slide out for easy access to product
- Heavy duty casters (2 swivel, 2 fixed)
- Load capacity 1,500 lbs.
- Durable powder coated finish



SCAN HERE FOR MANUAL



CATALOG NUMBER	DESCRIPTION	CAPACITY	WEIGHT	
5400	Wire Cage	1,500 lbs.	385 lbs	UPC# 811993026447

# JACKSON

## Jackson Tool Threader Stands

**Model 224W** Rolling Stand with tray

**Model 235W** Rolling Stand with storage box

- All metal construction
- Will fit RIDGID®\* 535 and 1224 threaders
- Large 15" Heavy Duty solid tires on all models
- Available with tray or lockable storage box
- Rear roller arm to help prevent tip-over while rolling
- Powder coated



MODEL 224W



MODEL 235W



SCAN HERE FOR MANUAL



CATALOG #	DESCRIPTION	WILL FIT RIDGID® MODEL #	WEIGHT	
224W	Rolling Stand with tray	1224   535 – 2001 and newer	102 lbs.	UPC# 811993024917
235W	Rolling Stand with storage box	1224   535 – 2001 and newer	129 lbs.	UPC# 811993024931

\*RIDGID® is a registered trademark of Emerson Electric, Inc.



# JACKSON

## Model 142 JP Jaw For PVC coated conduit

- JP Jaw Set is designed to hold 1/2"-2" PVC coated conduit
- JP Jaw Set helps protect PVC coating from damage
- Made from high-strength alloy
- Jaws are 6" long for firm grip
- For use with Ridgid®\* 40-A Tri-Stand Yoke Vise or Ridgid®\* 22 Bench Yoke Vise



SCAN HERE FOR MANUAL



CATALOG NUMBER	DESCRIPTION	CAPACITY	WEIGHT	
142	JP Jaw Set	1/2"-2"	5 lbs.	UPC# 811993025105

\*RIDGID® is a registered trademark of Emerson Electric, Inc.



## COMPARISON REFERENCE

Description	Sumner* Item #	RIDGID®** Item #	Greenlee*** Item #	Jackson Tool Item #	Page #
Chain Vise Stand	—	460-6	—	186	148
V-Head Pipe Stand	780375	56662	—	436	149
Pipe Horse™ Pipe Stand	780365	AR-99	—	536	154
Jumbo Jack™ Pipe Stand	781403	—	—	636	155
Tri-Clamp Pipe Alignment Tool	781130	—	—	301	156
	781150	—	—	302	156
	781170	—	—	303	156
Conduit Rack	783317	—	668	5050	157
Conduit Bundler	783320	—	GMX-670K	5070	158
Pipe/Material Cart	783230	—	—	5080	159
Mobile Container Cart	784990	—	—	5090	160
Pipe Wagon	—	—	36745	458	161
Yard Dog™ Pipe Hauler	780351	—	—	2508	162
Pipe Hanger Cart	785651	—	—	5050H	163
Piper Hanger Cart w/o Mesh	785650	—	—	5050HL	163
Wire Cage	784920	—	—	5400	164
<b>THREADER STANDS</b>					
Rolling Stand with tray, wide	—	150A	—	224W	165
Rolling Stand with storage box, wide	—	200A	—	235W	165

\* Sumner® is a registered trademark of Southwire, Inc.

\*\* RIDGID® is a registered trademark of Emerson Electric, Inc.

\*\*\* Greenlee® is a registered trademark of Greenlee Tools, Inc.



## Jackson Tool Limited Warranty

Jackson Tool extends the following Limited Warranty to the original owner:

If the Jackson Tool equipment shall prove to be defective in materials or workmanship during the **Limited Warranty period of two (2) years after the original delivery**, Jackson Tool, at its option, will repair or replace the defective equipment.

The warranty on any replacement equipment supplied hereunder will be limited to the unexpired term of the original warranty. Failures due to misuse and abuse are not covered by this warranty. No other warranty, expressed or implied, applies, including merchantability or fitness for a particular purpose. No employee, agent, dealer or another person is authorized to alter this or make any other warranty on behalf of Jackson Tool.

To obtain the benefit of this warranty, deliver the complete product, prepaid, to Jackson Tool or any Jackson Tool authorized repair center.

# JACKSON

*P.O. BOX 5701 • GREENVILLE, SC 29606*  
*877.522.8995 OR 864.721.4235*  
*FAX 864.721.4236*

[www.jacksontoolinc.com](http://www.jacksontoolinc.com)