

# JACKSON

## Model 186 Chain Vise Stand 1/8" to 6" Capacity

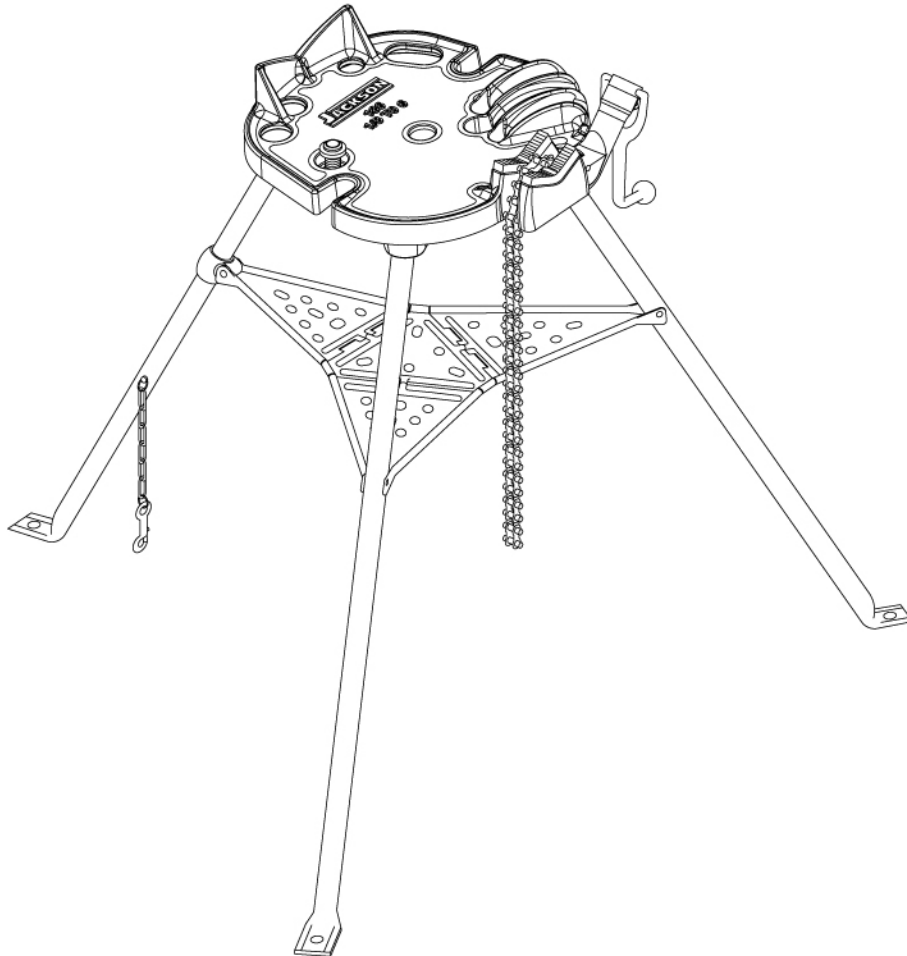

## Assembly, Safety, and Parts Manual

02/11 REV. 1



Read and understand this material before operating or servicing the Chain Vise Stand. Failure to understand how to safely operate and service this unit may result in property damage, personal injury or death. This unit should only be operated by qualified personnel.

This manual is free of charge. All personnel who assemble or operate this equipment should have a copy of this manual and read and understand its contents. To request a copy, call or write the address below.

**JACKSON TOOL, INC. • P.O. BOX 5701 • GREENVILLE, SC 29606**  
**877.522.8995 or 864.244.2544 • FAX 864.244.2128 • [www.jacksonstoolinc.com](http://www.jacksonstoolinc.com)**

## IMPORTANT SAFETY INFORMATION

**▲ CAUTION**

DO NOT exceed the capacity of the Chain Vise Stand.

**▲ CAUTION**

ALWAYS use on a smooth, level and firm surface.

**▲ CAUTION**

ALWAYS support the end of the pipe that extends beyond the head of the Chain Vise Stand.

**▲ CAUTION**

When extending and collapsing the legs, be careful of pinch points on the hinged tray.

**▲ CAUTION**

For best stability use the jackscrew provided or anchor the feet of the Chain Vise Stand to the floor.

## SPECIFICATIONS — 186 Chain Vise Stand

Weight Capacity – 450 lbs.

Pipe Capacity – 1/8" to 6"

Weight – 47 lbs.

## ASSEMBLY INSTRUCTIONS – 186 Chain Vise Stand

NOTE: Refer to Parts List and Exploded View on Page 4 for item numbers.

1. Place the head of the Chain Vise Stand ( Item #1 ) upside down on a flat surface.
2. Place the rear leg into the rear leg pocket on the head as shown in Figure 1 on Page 3. The rear leg is the leg that has the chain with latch and tray support. The foot of the leg should face outward. Attach the rear leg to the head with hex head cap screw and locknut. ( Items #9 and #10 )
3. Next, place the two (2) front legs into the two (2) pockets on the head as shown in Figure 1 on Page 3. Be sure the feet face outward. Attach each front leg to the head with hex head cap screw and locknut. ( Items #9 and #10 )

NOTE: The two (2) front legs are the same and may be placed in either front leg pocket.

4. To attach the hinged tray ( Item #26 ) face the hinged tray so that it collapses towards the head. See Figure 1. Pin the tray to the tray support ( Item #7 ) on the rear leg using a tray pin ( Item #5 ) and an X washer ( Item #6 ). Next, pin the tray to the two front legs through the holes provided in each front leg and attach each using tray pin ( Item #5 ) and an X washer ( Item #6 ). NOTE: The X washers are secured onto the tray pins by first pushing them into the groove in the tray pin and then pinching the long ends together with pliers.
5. Make sure all hardware is secure. Set the Chain Vise Stand in the upright position with the feet on the floor. With the Chain Vise Stand in this position, the hinged tray should lock the legs firmly in place. To adjust the leg stiffness, turn the Chain Vise Stand upside down with the head on the floor and the hinged tray in the loose position. Next, loosen the set screw on the tray support and move the tray support as follows:
  - Increase stiffness by moving the tray support toward the head.
  - Decrease stiffness by moving the tray support toward the feet.

Tighten the set screw on the tray support and return the Chain Vise Stand to the upright position. Repeat adjustment if necessary.

# ASSEMBLY INSTRUCTIONS – 186 Chain Vise Stand *continued . . .*

Figure 1

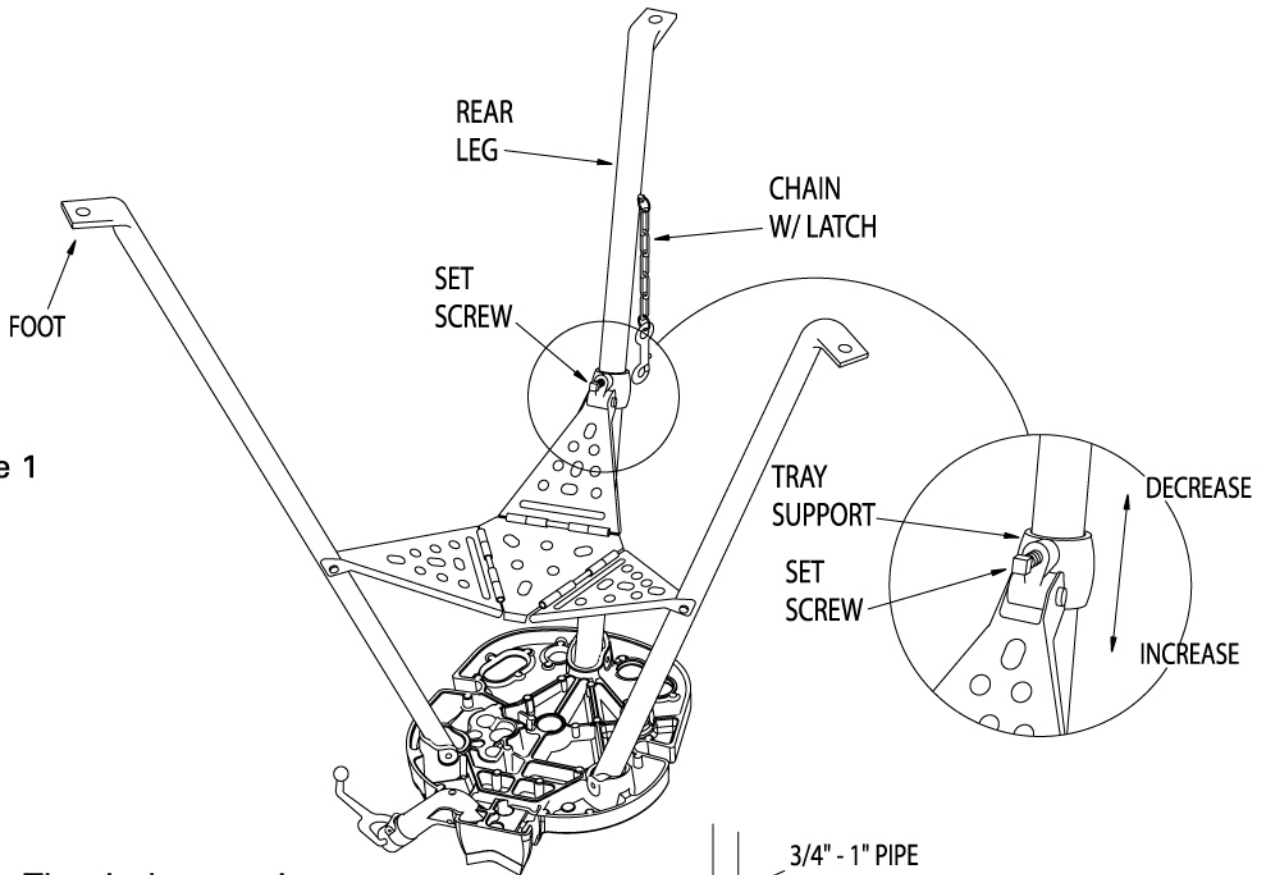

NOTE: The jackscrew is provided to help prevent tipping. Use a piece of 3/4" or 1" pipe as a brace against the ceiling to help anchor the Chain Vise Stand. Be sure the ceiling is capable of supporting the load that will be placed against it.

For heavy pipe, the feet of the Chain Vise Stand legs may also be anchored to the floor.

NOTE: 3 bending grooves are provided on the Chain Vise Stand head. Place pipe, conduit or tubing into holes and pull downward into the grooves. Before bending be sure the Chain Vise Stand is secured to prevent tipping.

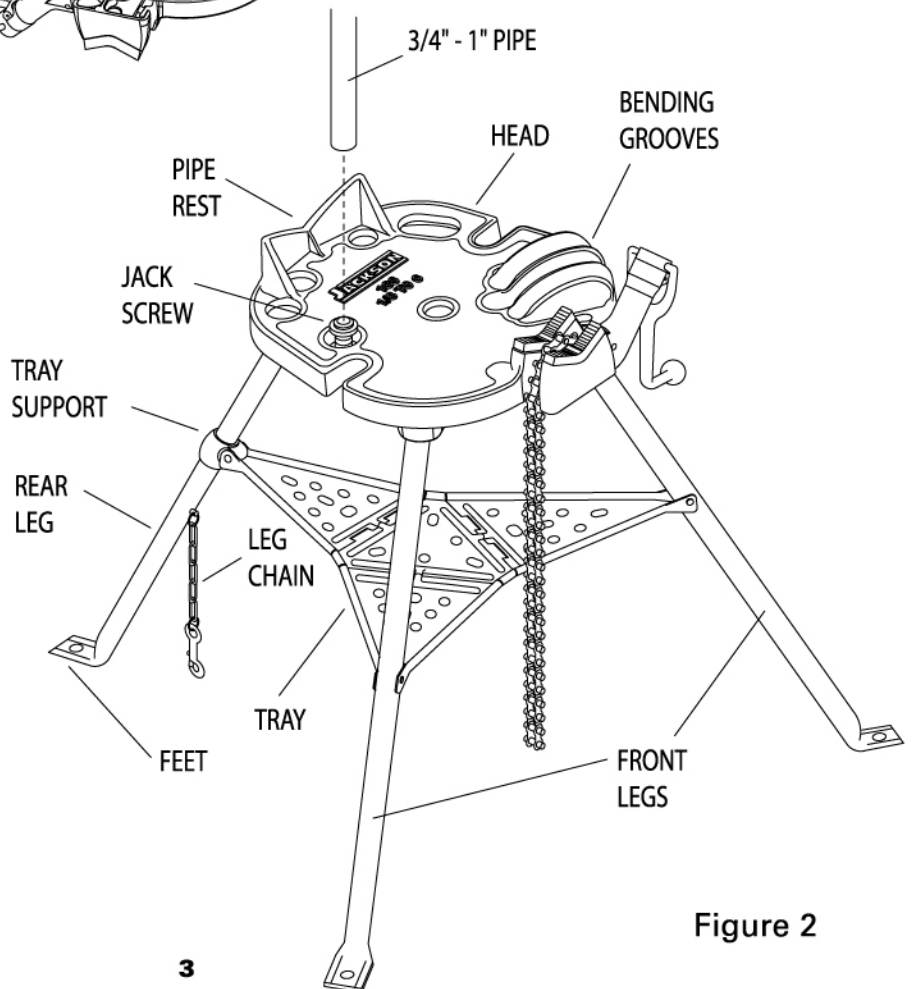
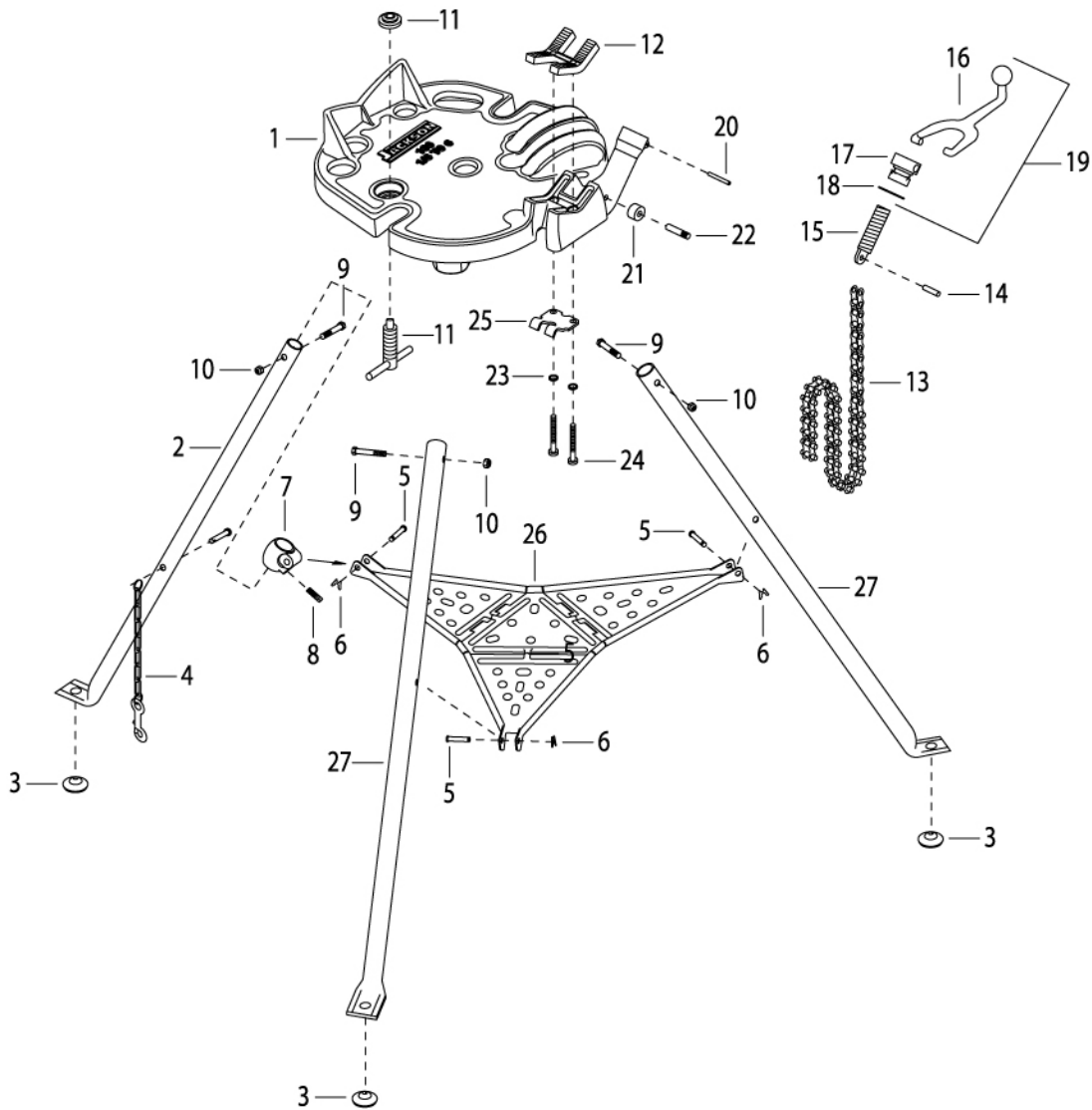

Figure 2

## EXPLODED VIEW — 186 Chain Vise Stand



## PARTS LIST — 186 Chain Vise Stand

ITEM #	PART #	QTY	DESCRIPTION	ITEM #	PART #	QTY	DESCRIPTION
1	186-1	1	Head (includes Item #11)	15	186-580	1	Chain Screw
2	186-2	1	Leg, Rear (includes Item #3, #4)	16	186-16	1	Handle
3	186-609	3	Grommet	17	186-578	1	Nut - Swivel (includes item #18)
4	186-4	1	Leg Chain Assembly	18	186-18	1	Friction Ring
5	186-5	3	Pin, Hinge Tray (includes item #6)	19	186-19	1	Handle Assembly (includes Items #16, #17, #18)
6	186-6	3	X Washer	20	186-20	1	Pin - Roll
7	186-634	1	Tray Support w/ Set Screw	21	186-575	1	Roller
8	186-8	1	Screw, Set	22	186-579	1	Pin - Roller
9	186-9	3	Screw, Hx Head, 3/8" - 16 x 2 3/4"	23	186-23	2	Washer - Lock, 5/16"
10	186-10	3	Nut, Nylon Insert - 3/8" - 16	24	186-24	2	Screw, 5/16" - 18 x 2"
11	186-11	1	Jackscrew Assembly	25	186-639	1	Chain Plate (includes items #23, #24)
12	186-573	1	Jaw - Standard	26	186-620	1	Hinged Tray
	186-672	1	Jaw - For PVC Coated	27	186-27	2	Front Leg (includes Item #3)
13	186-13	1	Chain				
14	186-14	1	Pin - Chain				