

# JACKSON

## Model 5050H Pipe Hanger Cart

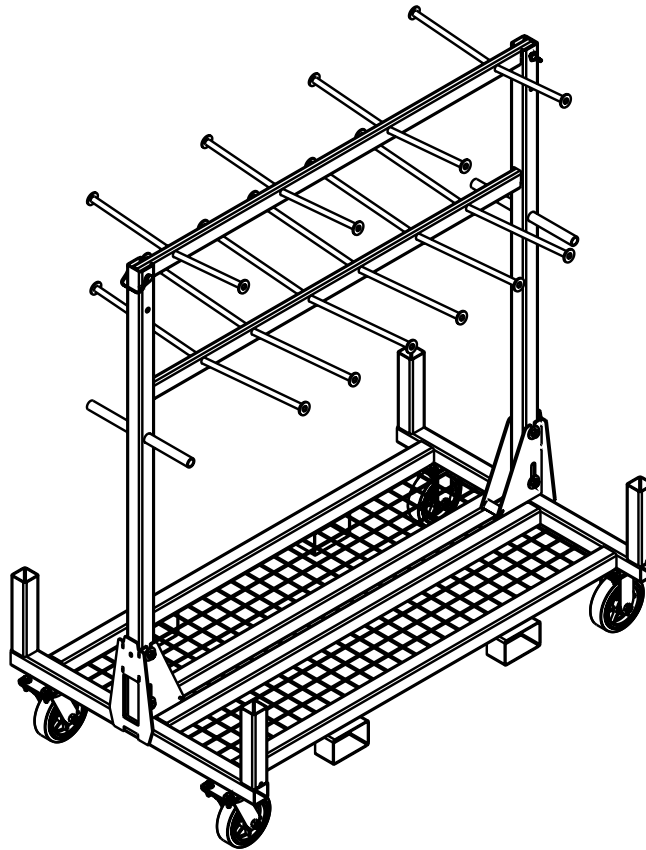

## Assembly, Safety and Parts Manual

02/2023



**Read and understand this material before operating or servicing the Pipe Hanger Cart. Failure to understand how to safely assemble, operate and service this unit may result in property damage, serious injury or death.**

This manual is free of charge. All personnel who operate this Pipe Hanger Cart should have a copy of this manual and read and understand its contents. To request a copy, call or write to the address below.

**JACKSON TOOL • P. O. BOX 5701 • GREENVILLE, SC 29606**  
**877-522-8995 or 864-721-4235 • FAX 864-721-4236 • [www.jacksonstoolinc.com](http://www.jacksonstoolinc.com)**

## IMPORTANT SAFETY INFORMATION

- ⚠ CAUTION** DO NOT exceed the capacity of the Pipe Hanger Cart.
- ⚠ CAUTION** ONLY roll on a firm, flat smooth surface.
- ⚠ CAUTION** ALWAYS load lower arms before the top arms and unload top arms before the lower arms.
- ⚠ CAUTION** ALWAYS assemble the Pipe Hanger Cart according to the instructions section, using only parts provided by CurrentTools.

## SPECIFICATIONS – 5050H PIPE HANGER CART

<b>Weight Capacity</b>	1000 lbs. evenly distributed
<b>Pipe Hanger Size</b>	40 — 6" to 8" hangers 120 — 2" to 4" hangers

## ASSEMBLY INSTRUCTIONS

1. From the storage position (see page 4), remove and set aside the two pipe hanger tube sections. Then, raise one of the upright tubes to the vertical position. Ensure the upper bolt is resting in the slot at the top of the gusset. All the flat washers should be on the outside of the gusset. Repeat for the second upright tube. At this point, DO NOT fully tighten the nuts on the bolts.

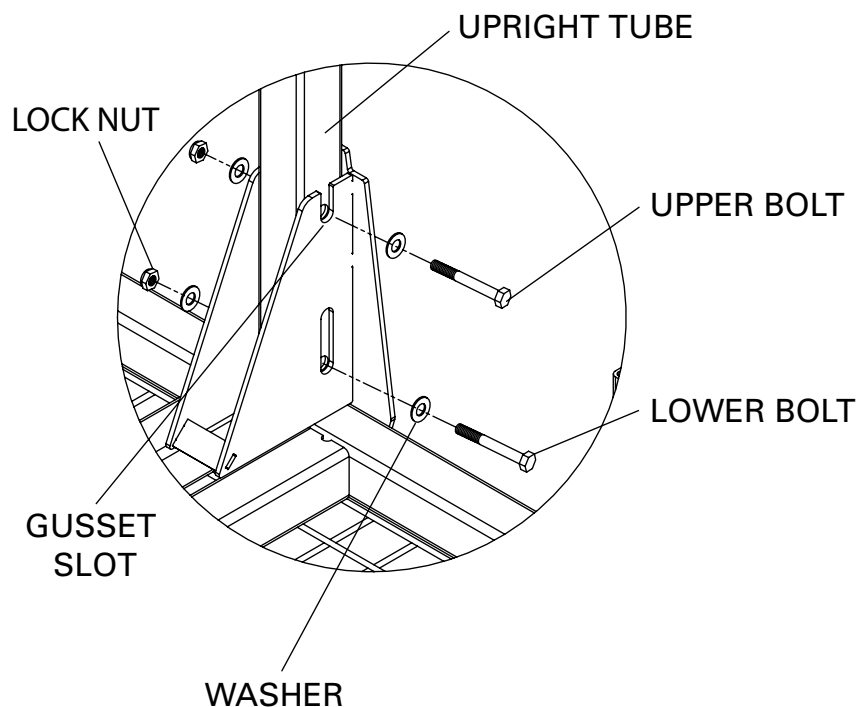

## ASSEMBLY INSTRUCTIONS — CONTINUED

- Spread both upright tubes apart and insert one end of the lower pipe hanger tube into one of the lower slots with the hanger rods angled upward (see Figure 3A). Then, insert the opposite end of the lower pipe hanger tube into the other upright tube's lower slot. Ensure the lower pipe hanger tube is fully inserted on both ends (see Figure 3B).

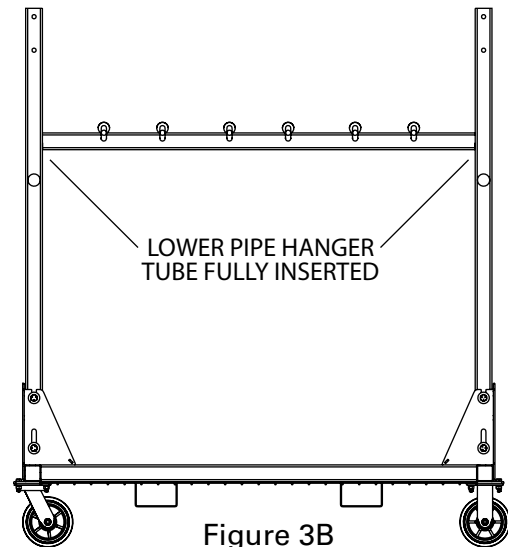
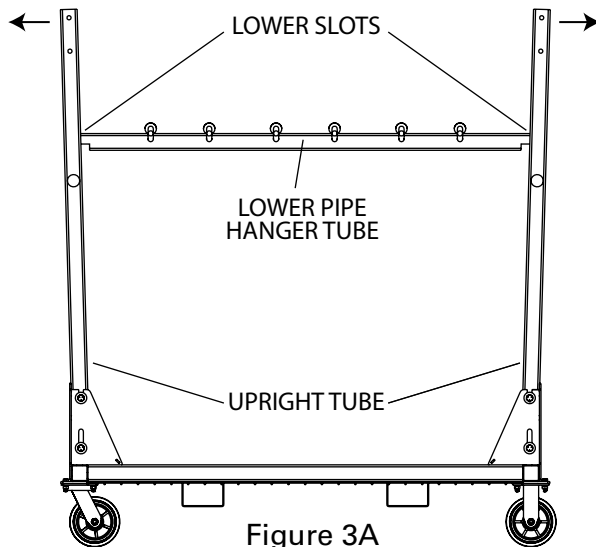

- Install the upper pipe hanger tube by inserting the notch at both ends of the upper pipe hanger tube into the top of the upright tubes until fully seated (see Figure 3C). Insert the two locking retainer pins into the holes at the top of the upright tubes and secure. Tighten the two upper bolts and two lower bolts to secure the upright tubes to the base.

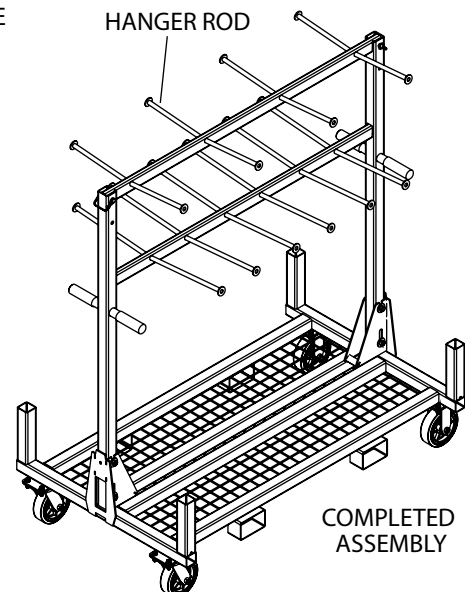
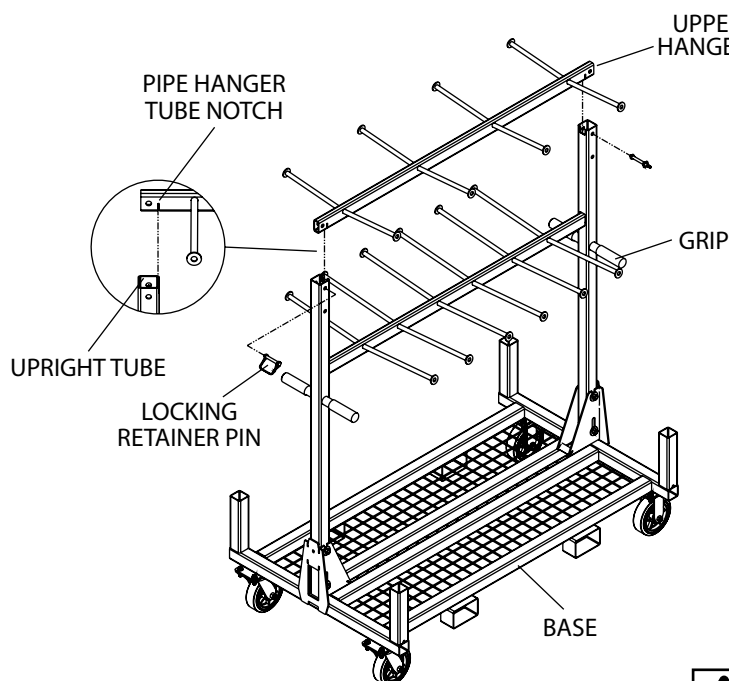

**CAUTION**  
Ensure all bolts are  
tightened prior to use

## STORAGE POSITION

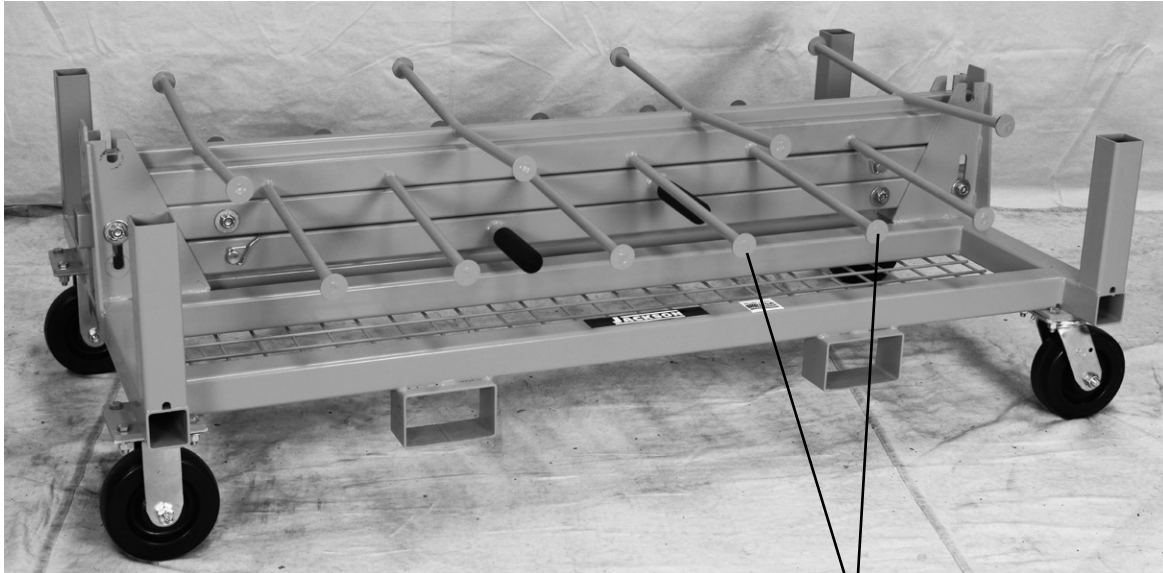

NOTE: The lower pipe hanger tube is inserted with the hanger rods angling downward.

## EXPLODED VIEW / PARTS LIST

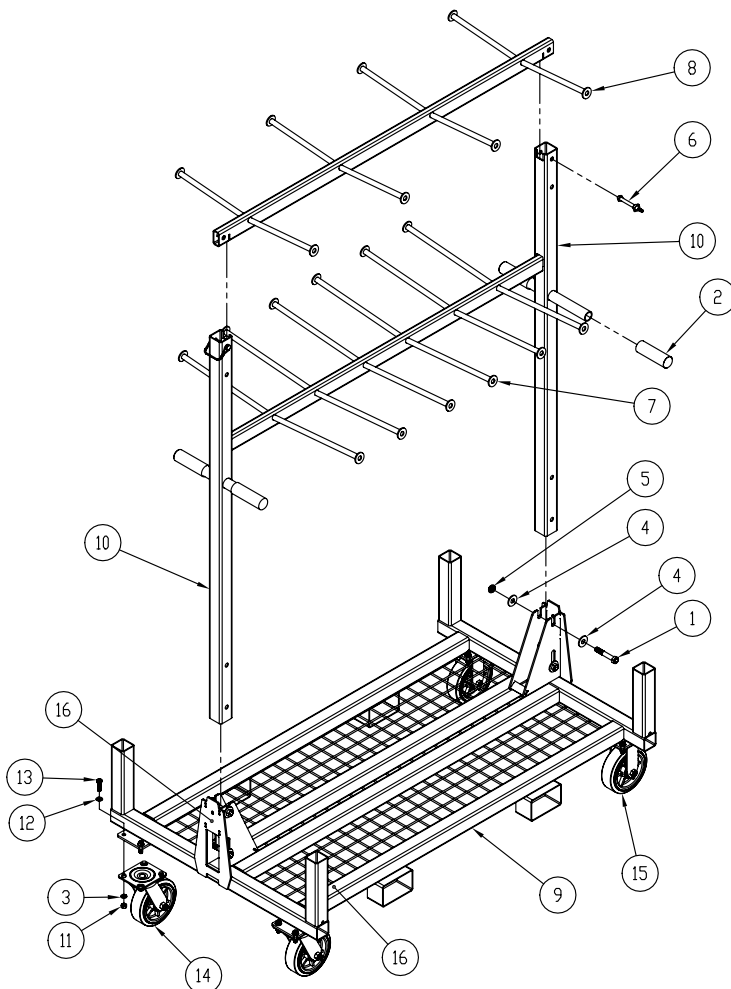

PARTS LIST – 5050H			
ITEM#	PART#	DESCRIPTION	QTY
1	66-67	SCREW – HEX HEAD CAP GR5 ZINC 1/2-13 × 3 1/4)	4
2	458-1	GRIP	4
3	452-27	3/8 LOCK WASHER	16
4	5050-2	.50 ID X 1.37 OD × .11 WASHER	8
5	5050-4	NUT – HEX (1/2-13) THIN NYLON INSERT	4
6	5050H-001	LOCKING PIN / WIRE RETAINER	2
7	5050H-101	LOWER PIPE HANGER TUBE	1
8	5050H-102	UPPER PIPE HANGER TUBE	1
9	5050H-105	BASE W/MESH	1
10	5050H-113	UPRIGHT TUBE	2
11	452-28	3/8 HEX NUT	16
12	506-3	WASHER – FLAT 3/8 (USS) ZINC	16
13	281-2D	SCREW – HEX HEAD CAP GR5 ZINC (3/8-16 × 1.25)	16
14	506-1	CASTER – SWIVEL	2
15	506-2	CASTER – FIXED	2
16	5050H-DECAL SET	DECAL SHEET	1